

PELLET FIREPLACE

PELLKAMIN2 12



CONTENTS

Safety information	4	<i>The contents from page 5 to page 29 are meant for the installer</i>
Dimensions	5	
Technical data	7	
Unpacking	8	
Packaging	10	
Installation (fume discharge, air intake)	12	
Connections on the terminal boards	15	
Fastening the product and the base (optional)	16	
Fitting the components (according to the version)		
• Pellet loading trapdoor	17	
• Ducted ventilation	18	
• Frontal ventilation kit	21	
• Pellet loading drawer	24	
Notes on cladding	28	
Fitting the inlet surround	29	
Instructions for use	30	
Maintenance	39	
Troubleshooting	42	

NOTE

Pellkamin is available in four versions:

1. with ducted ventilation and a pellet loading trapdoor (see the fitting sections on "Ducted Ventilation" and "Loading Trapdoor")
2. with frontal ventilation and a pellet loading trapdoor (see the fitting sections on "Frontal Ventilation Kit" and "Loading Trapdoor")
3. with frontal ventilation and a pellet loading drawer (see the fitting sections on "Frontal Ventilation Kit and drawer")
4. with ducted ventilation and a pellet loading drawer (see the fitting sections on "Pellet loading drawer" and "Ducted Ventilation")

This manual provides users with instructions on how to install and use all four versions. The numbers at the side of the table of contents indicate the pages for that/those version(s).

The undersigned company, EDILKAMIN S.p.A., with registered office in Via Vincenzo Monti 47 - 20123 Milan (Italy) - Italian Tax ID code and VAT number 00192220192

Hereby declares, under its sole responsibility, that:
The product mentioned below complies with EU Regulation 305/2011 and the harmonised EU standard EN 14785:2006

PELLET FIREPLACE, bearing the
EDILKAMIN brand, known as PELLKAMIN2 12

SERIAL NO.: Rating plate reference
Performance declaration: (DoP - EK No. 176):
Rating plate reference

Moreover, the company hereby declares that:
PELLKAMIN2 12 complies with the requirements in the following European Directives:
2014/35/EC - Low Voltage Directive
2014/30/EC - Electromagnetic Compatibility Directive

Dear Sir/Madam

Congratulations on choosing our product. Before you use it, please read this manual carefully, to get the best from your new appliance in total safety.

This manual is an integral part of the product. Please keep it for the entire life of the product.

If you lose it, you can request a copy or download it from www.edilkamin.com

After unpacking the product, check the condition and completeness of the contents.

In the event of error, immediately contact the retailer where the purchase was made, providing him with a copy of the warranty booklet and the sales receipt.

The appliance must be installed and operated in compliance with local and national law and European regulations. For the installation, and for anything not specifically indicated in the manual, observe local regulations.

The diagrams in this manual are illustrative; they do not always refer specifically to your product and are not binding in any way.

The product is uniquely identified by a number, the "counterfoil", which is indicated on the warranty certificate inside the product.

Please keep:

- the warranty certificate accompanying the product
- the purchase receipt given to you by the retailer
- the declaration of conformity given to you by the installer.

The warranty conditions are given in the warranty certificate accompanying the product.

We recommend that the appliance be started up for the first time (commissioned) by a qualified Edilkamin technician.

In Italy, commissioning by an authorised technician is required by UNI 10683, and is recommended in all countries to ensure best results from the product.

This consists in:

- checking the installation documents (declaration of conformity) and the quality of the installation itself;
- calibrating the product to suit its actual application
- explanation to the end user and issue of complementary documentation (commissioning certificate)

Having the appliance commissioned properly ensures that it will operate to best effect and in complete safety. Proper commissioning is required for activation of the Edilkamin warranty. The warranty is only valid in the country of sale of the product.

If the appliance is not commissioned by an authorised technician, Edilkamin will not provide warranty service. See the warranty booklet for details. The above terms do not affect the reseller's legal responsibility for the legal warranty.

The warranty covers only demonstrable manufacturing defects and not, for instance, problems resulting from improper installation or calibration.

MEANING OF SYMBOLS

In some parts of the manual the following symbols are used:



PLEASE NOTE:

carefully read and understand the message in question, since failure to follow the instructions in it could cause serious damage to the product and put the safety of those using it at risk.



INFORMATION:

failure to comply with these requirements will compromise product use.



OPERATING SEQUENCE:

follow the instructions for the operations described

- The appliance is not designed for use by people, including children, with limited physical, sensory and mental capacities.
- The appliance is not intended to be used for cooking.
- The appliance is designed to burn UNI EN ISO 17225-2 category A1 wood pellets, in the amounts and manner described in this manual.
- The appliance is designed for use indoors, in normal conditions of ambient humidity.
- Keep the product in a dry place out of the weather.
- For the legal and company warranties, refer to the warranty certificate inside the product: neither Edilkamin nor the reseller are liable for damage resulting from incorrect installation or maintenance.

Safety risks may be caused by:

- installation in unsuitable conditions. In particular, conditions of fire hazard. **DO NOT INSTALL THE PRODUCT IN AREAS SUBJECT TO THE RISK OF FIRE.**
- contact with fire and hot parts (e.g. glass panel and pipes). **DO NOT TOUCH THE FIREPLACE'S HOT PARTS;** always wear the provided gloves when working with the fireplace, even if switched off, when it is still hot. Failure to do so can result in burns.
- contact with live electrical equipment (internal). **DO NOT ACCESS THE INTERNAL ELECTRICAL EQUIPMENT WHILE THE APPLIANCE IS POWERED ON.** Electrocution hazard.
- use of improper ignition aids (e.g. alcohol). **DO NOT IGNITE OR BOOST THE FLAME WITH FLUID SPRAYS OR A FLAME TORCH.**
- use of fuel other than wood pellets. **DO NOT BURN WASTE MATTER, PLASTIC OR OTHER MATERIALS THAN WOOD PELLETS IN THE HEARTH.** The product may be soiled, the flue may catch fire, and environmental damage may ensue.
- cleaning the hearth when hot. **DO NOT CLEAN THE HEARTH WITH A VACUUM CLEANER WHILE IT IS HOT.** Risk of damage to the cleaner and smoke in the room.
- cleaning the fumes duct with cleaning products. **DO NOT CLEAN THE PRODUCT WITH FLAMMABLE PRODUCTS.** Risk of fire and blowback.
- cleaning the hot glass pane with unsuitable cleaning products. **DO NOT CLEAN THE GLASS WHILE IT IS HOT WITH WATER OR ANY OTHER PRODUCT THAN THE RECOMMENDED GLASS CLEANING PRODUCTS.** Risk of cracking and

irreparable damage to the glass.

- storing flammable materials within the safety clearance indicated in this manual. **DO NOT PLACE LAUNDRY ON THE PRODUCT. DO NOT PLACE DRYING RACKS WITHIN THE SAFETY CLEARANCE.** Keep flammable fluids away from the product. Fire hazard.
- blocking the aeration vents and air intakes in the room. **DO NOT BLOCK THE AERATION VENTS OR FLUE.** Risk of smoke returning into the room with consequent damage and injury.
- use of the product as a support or ladder. **DO NOT CLIMB ONTO THE PRODUCT OR USE IT AS A SUPPORT.** Risk of damage and injury.
- use of the fireplace with the hearth open. **DO NOT USE THE PRODUCT WITH ITS DOOR OPEN.**
- incandescent material projected from the open door. **DO NOT throw incandescent material outside the appliance.** Fire hazard.
- use of water in case of fire. **CALL THE AUTHORITIES IF A FIRE BREAKS OUT.**

Please use all normal precautions for a household heating appliance.

If you have doubts, please do not take any action, but contact the retailer or the installer.

For reasons of safety, read the user instructions included in this manual.

PELLKAMIN2 12 with ducted ventilation and a pellet loading trapdoor

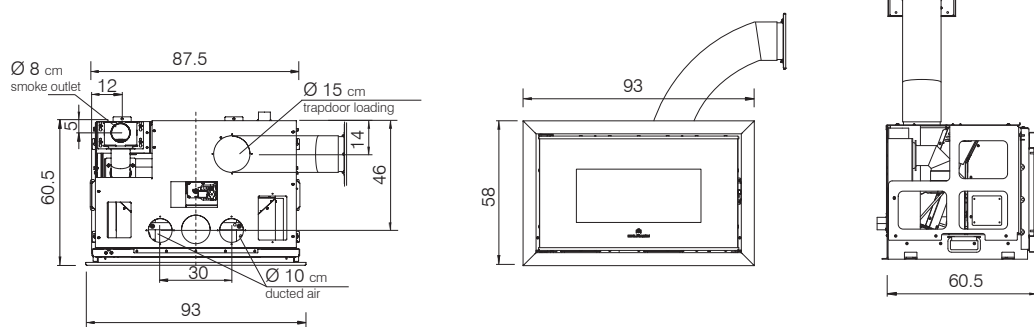

PELLKAMIN2 12 with frontal ventilation and a pellet loading trapdoor

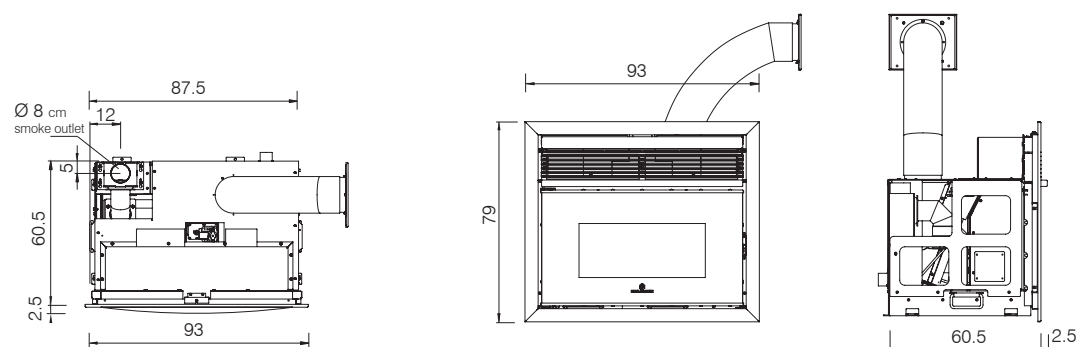

PELLKAMIN2 12 with frontal ventilation and a pellet loading drawer

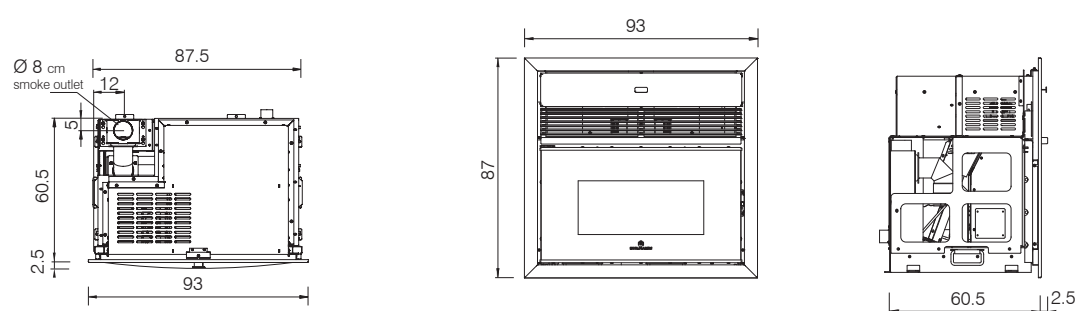

PELLKAMIN2 12 with ducted ventilation and a pellet loading drawer

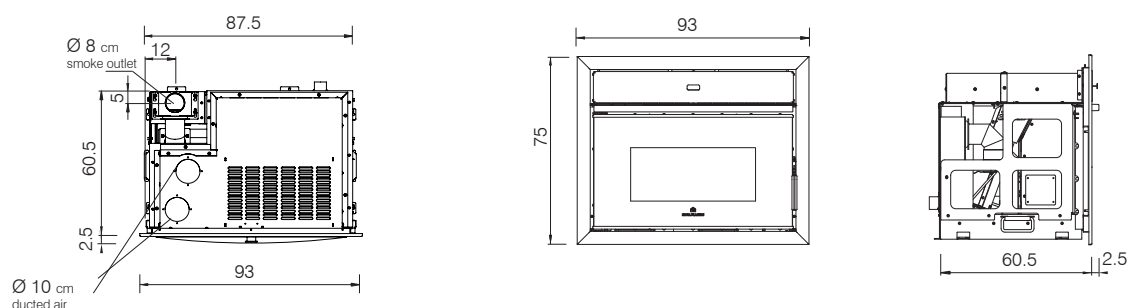

THE REAR THAT IS THE SAME FOR ALL FOUR MODELS

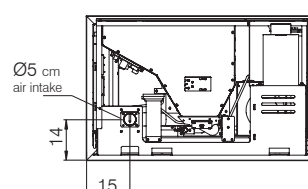

Example of minimum recommended dimensions for installation with fans at the bottom and optional stand at minimum height. This example for illustrative purposes only. Holes should also be made for: the fume discharge (flue); the combustion air inlet; ventilation air recovery (a 10x10 cm hole in the side of the covering)

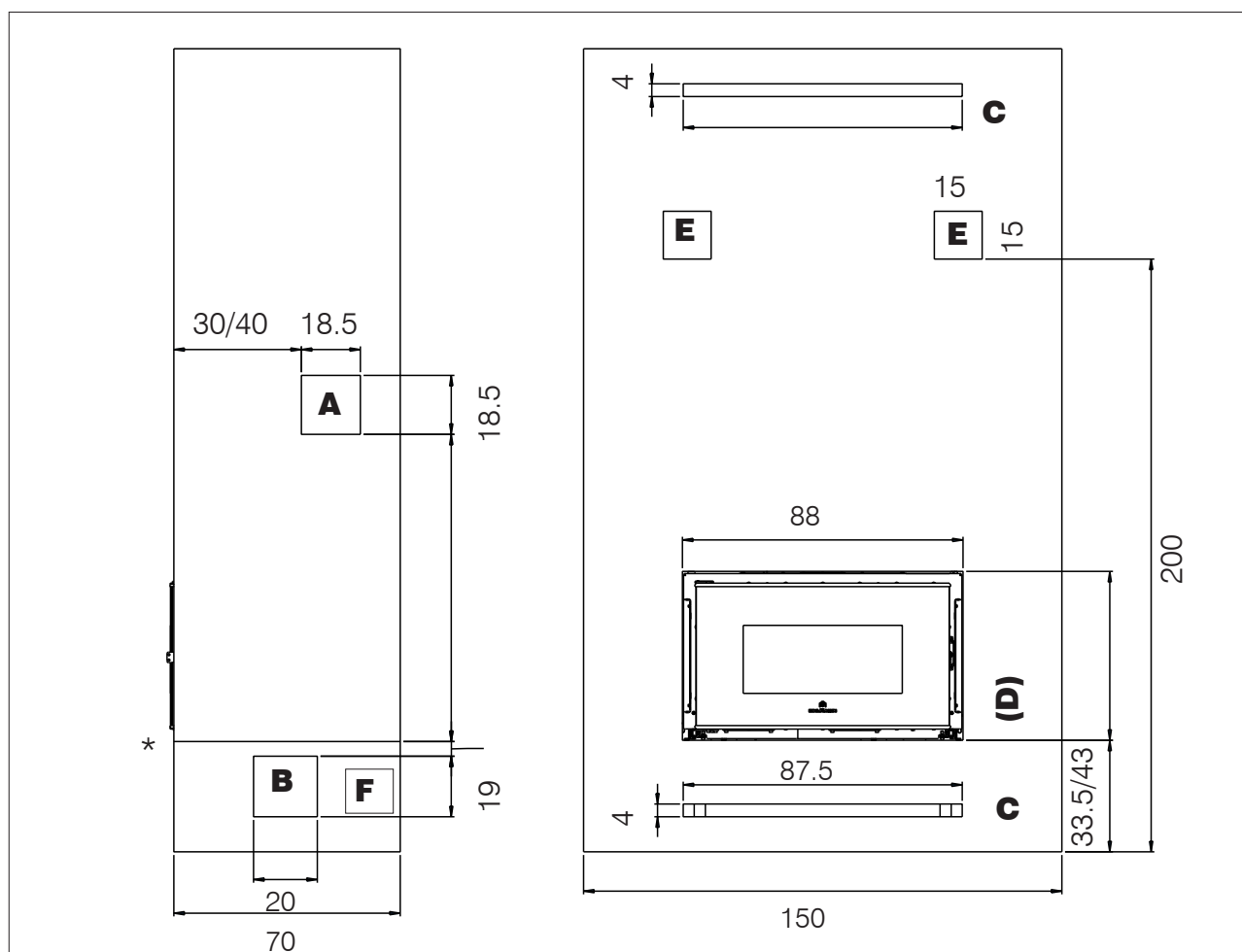

* Do not exceed the height of the base with the cladding. This is so that the maintenance technician can slide the appliance out on its rails during maintenance work.

Legend

- A = hole for pellet loading trapdoor (on the side, can also be installed on the front)
B = hole for fan housing (on the side at the bottom)
C = hole for compensation vent
D = hole for the product
E = hole for the vents (Split/Bent/Origami/Sharp)
F = hole for ventilation air recovery (a 10x10 cm hole in the side of the cladding)

MEASUREMENTS (cm) OF HOLES ON PLASTERBOARD

Fan housing	19 x 20
Vents (Split/Bent/Origami/Sharp)	15 x 15
Label Vents	87.5 x 4
Pellet loading trapdoor	31 x 21
Hole for ventilation air recovery	10 x 10

The drawing represents the version with trapdoor loading and ducted ventilation.

The pellets can be loaded even when the fire is burning.
Also estimate a space for the simplified ignition button.

TECHNICAL CHARACTERISTICS EN 14785

	Nominal power	Reduced power	
Available power	12,6	3,8	kW
Efficiency	92,1	93,8	%
CO emissions at 13% O ₂	0,005	0,018	%
Fumes temperature	143	81	°C
Fuel consumption*	2,9	0,8	kg/h
Tank capacity	17		kg
Draw	12 - 5	10 - 3	Pa
Autonomy	6	21	ore
Heatable volume **	330		m ³
Fumes outlet diameter (male)	80		mm
Air intake diameter (male)	50		mm
Weight including packaging	cod. 809530-218 kg; cod. 809560-271 kg; cod. 809550-249 kg; cod. 809580-273 kg		kg
Energy efficiency classes (2015-1186 Regulation)	A+		

*A calorific value of 4.8 kW/Kg has been used to calculate consumption *

* The heatable volume is calculated based on the assumption of a heating demand of 33 Kcal/m³ hour.

TECHNICAL DATA FOR RATING THE FLUE

which must in any case satisfy the requirements of this sheet and the installation instructions for the product

	Nominal power	Reduced power	
Fumes temperature at outlet	172	97	°C
Minimum draw	0,01		Pa
Fumes flow rate	7,9	4,1	g/s

ELECTRICAL SPECIFICATIONS

Power	230 Vac +/- 10% 50 Hz
Mean absorbed power	130 W
Power absorption during ignition	300 W
Remote control frequency (provided)	2,4 GHz
Logic board protection	Fusibile T4A, 250 Vac 5x20

The above data are illustrative and are drawn from the certification by a notified body.

EDILKAMIN s.p.a. reserves the right to modify the product without notification in the interests of improvement.

PREPARATION AND UNPACKING

The packaging materials are neither toxic nor noxious and do not require special disposal.

The user is responsible for storing, disposing of and recycling them in a regulatory fashion.



Always move the stove vertically with suitable equipment and in observance of safety regulations.

Do not turn the package over, and handle all parts requiring installation with care.

CONTENTS OF PACKAGE

The packaging varies according to the Pellkamin version.

The packages are described in the "Packaging" section.



The air outlet vents are not included in the versions with ducted ventilation, but you can choose them according to your preference from the available models at your retailer's showroom. The warm ventilation air must be ducted to the outside.

The product contains:

The remote control, the warranty certificate, the glove, this manual and the desiccating salts. The lever for opening the door is on the pallet.

Check that all components are present and in good condition; if you encounter any problems, contact your retailer immediately.

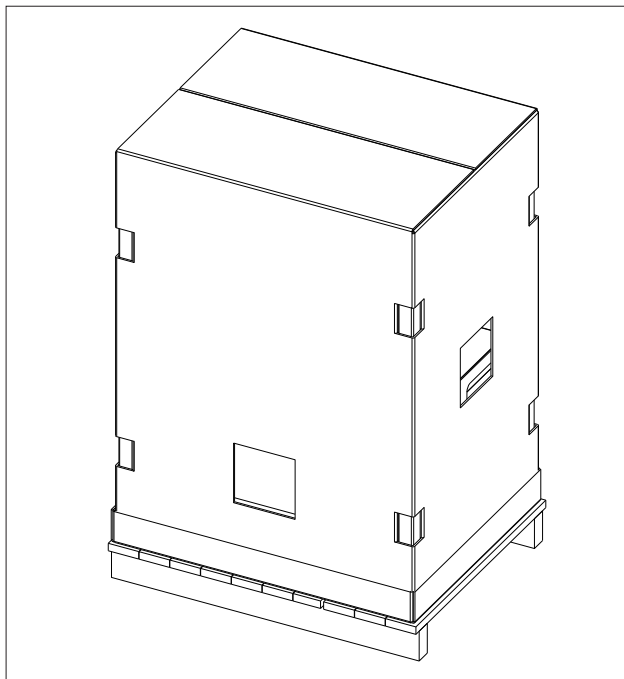

There are two deflectors in the firebox (**D**) to be fitted as shown in the figure below

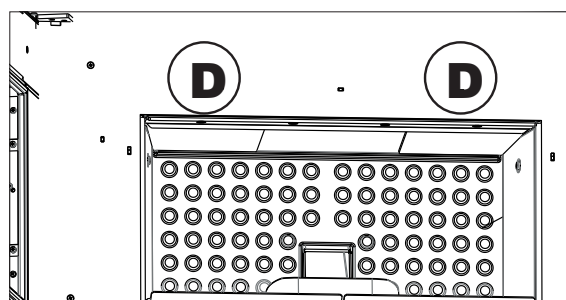
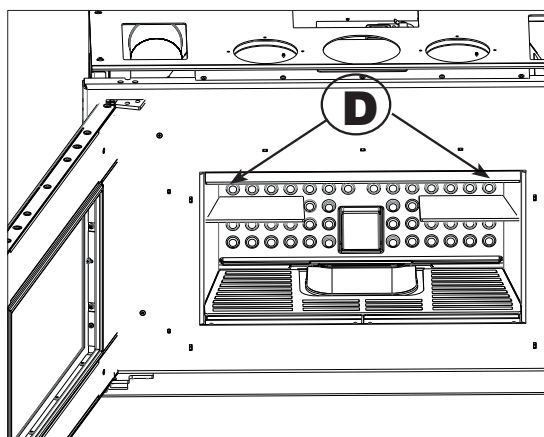

TO UNPACK THE PRODUCT, undo screws
(A) as shown below

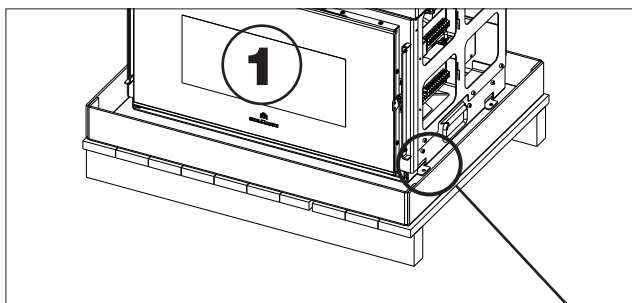

To facilitate handling, the PELLKAMIN2 12 is fitted with handles **(B)**.
Do not use the air intake or fumes outlet to handle the appliance. This may lead to slight misalignments.

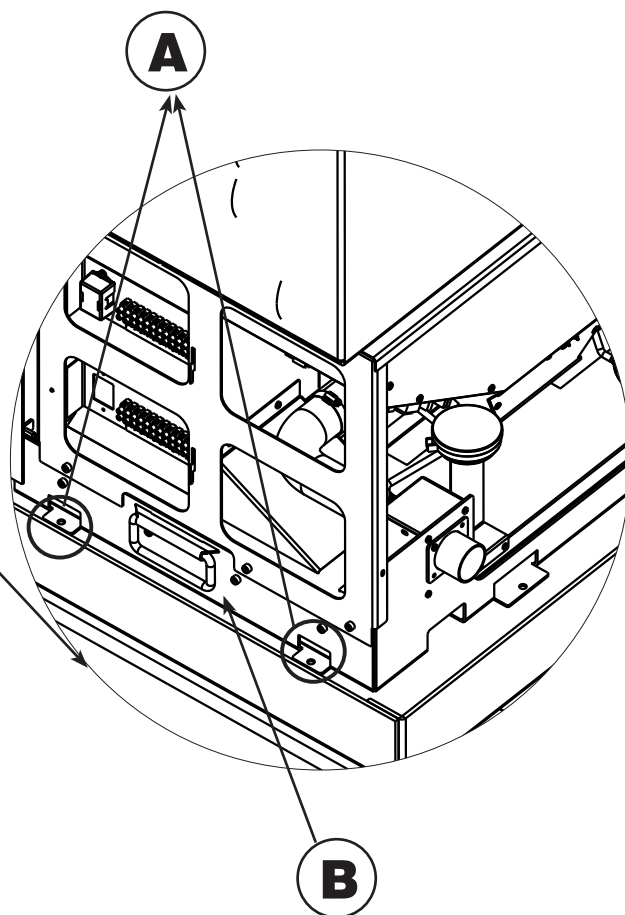

Pellkamin is available in four versions:

1. with ducted ventilation and a pellet loading trapdoor (see the fitting sections on "Ducted Ventilation" and "Loading Trapdoor")
2. with frontal ventilation and a pellet loading trapdoor (see the fitting sections on "Frontal Ventilation Kit" and "Loading Trapdoor")
3. with frontal ventilation and a pellet loading drawer (see the fitting sections on "Frontal Ventilation Kit and drawer")
4. with ducted ventilation and a pellet loading drawer (see the fitting sections on "Pellet loading drawer" and "Ducted Ventilation")

Version 1 with ducted ventilation and pellet loading trapdoor

The pack for the version with ducted ventilation and pellet loading trapdoor (1) consists of one package containing:

- the Pellkamin frame
- the trapdoor loading system
- the two compensation vents
- the fan kit and the ducting for the ducted ventilation system
- the inlet surround

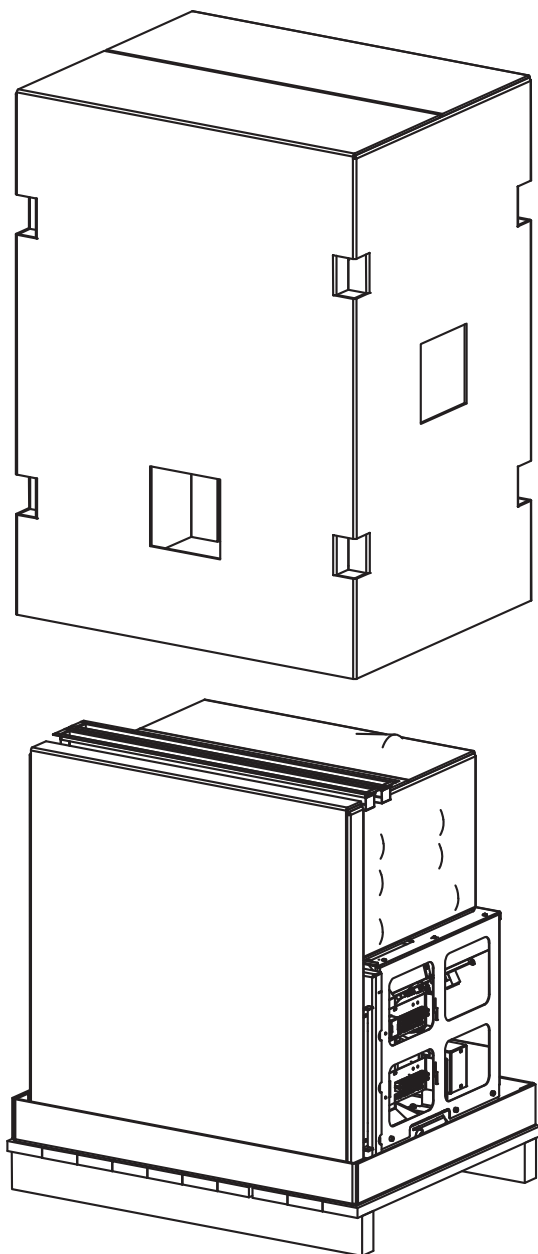

The pack for the versions 2, 3 and 4 consist of two packages

Version 2 with ducted ventilation and pellet loading trapdoor

One package (1):

- with the Pellkamin frame
- the trapdoor loading system
- the inlet surround
- the two compensation vents

One package (2) with

- the frontal ventilation kit

Version 3 with frontal ventilation and pellet loading drawer

One package (1) with

- the Pellkamin frame
- the two compensation vents
- the inlet surround

One package (2) with

- the drawer and frontal ventilation Kit

Version 4 with ducted ventilation and pellet loading drawer

One package (1) with

- the Pellkamin frame
- the fan kit and the ducting for the ducted ventilation system
- the two compensation vents
- the inlet surround

One package (2) with

- the pellet loading drawer

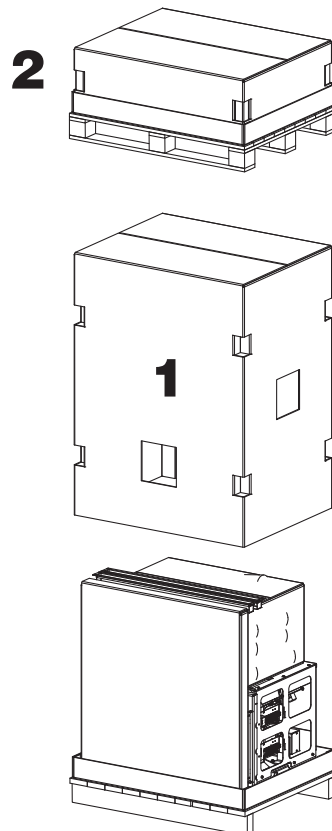

SUMMARY INSTALLATION CHECKS

For details, refer to the respective pages of this manual.

Element to be checked	What to check
Suitability of the room	<ul style="list-style-type: none"> aeration intended use: do not install in bedrooms, bathroom or fire hazard areas
Volume of room	<ul style="list-style-type: none"> > 30 m³
Load bearing capacity of the floor/base	<ul style="list-style-type: none"> sufficient to support the product, its accessories and cladding
Safety clearance from flammable materials	<ul style="list-style-type: none"> see the respective paragraph
Air intake	<ul style="list-style-type: none"> existing and suitable see the respective paragraph
Flue	<ul style="list-style-type: none"> see the respective paragraph <p>In particular, it must be:</p> <ul style="list-style-type: none"> dedicated to a single appliance made of suitable material; inspectable
Power socket	<ul style="list-style-type: none"> present, with regulatory grounding system
Hole for ventilation air	<ul style="list-style-type: none"> a hole at least 10x10 cm in size, preferably on the side of the covering
Ducting for ventilation air *	<ul style="list-style-type: none"> always channel the ventilation warm air (the 6 cm diameter pipe) to the outside

INSTALLATION IN AN EXISTING FIREBOX

In addition to the above, check, in particular, for

If you wish to install the appliance in an existing firebox, you must bear the following in mind, in addition to observing all regulations and the instructions in this manual:

- there must be sufficient clearance around the Pellkamin
- the possibility of installing the appliance perfectly level on the base *
- there must be room for the fan kit and loading trapdoor
- the existing cladding must be accessible for installing and, in particular, for checking the fan kit*. For maintenance purposes, the technicians are able to slide the Pellkamin out on its rails.

*if provided for in the version you have purchased

REMARKS ON INSTALLATION

Note that:

- The appliance may only be installed by a qualified technician authorised to issue the declaration of conformity.
- The appliance must be installed and operated in compliance with local and national law and European regulations. The applicable Italian regulation is UNI 10683.
- If installed in a condominium, the appliance must be approved by the administrator.

We give some general instructions below, however these do not obviate the need to comply with local regulations and do not affect the installer's liability for the installation.

Checking the suitability of the installation space

- The room must have a volume of at least 30 m³
- The floor must be able to bear the weight of the product and its accessories.
- Level the appliance
- The appliance may not be installed in a bedroom, bathroom or in the same room as other equipment which draws air for combustion from the room itself, or in any area with an explosive atmosphere. Any extraction fans operating in the same room or area as the product, may affect its draw.
- In Italy, check the compatibility pursuant to UNI 10683 and UNI 7129 in the presence of gas fired products.

Protection from heat and safety clearances

All adjacent surfaces must be protected against overheating. The insulation to be used will depend on the type of surface in question. Observe the following clearances from flammable materials:

- 15 cm at the sides and back

Positioning the product

The product is designed to operate in all climatic conditions. In special circumstances, such as strong wind, its safety equipment may switch the fireplace off. Contact the authorised Edilkamin Technical Assistance Centre.

FLUE SYSTEM

(Fumes duct, flue and chimney pot)

This chapter has been drawn up pursuant to European regulations EN 13384, EN 1443, EN 1856 and EN 1457. The installer must observe both these and any other local regulations. This manual does not in any way substitute such regulations. The product must be connected to a flue system which ensures that the fumes produced by combustion are exhausted in complete safety.

Before positioning the product, the installer must check that the flue pipe is properly rated.

FUMES DUCT, FLUE

The fumes duct (which connects the hearth's fumes outlet with the flue) and the flue itself must, among other regulatory requirements:

- receive the fumes from a single product (the outlets of multiple appliances may not be conveyed into a single flue)
- be routed vertically for the most part
- have no downwards sloping sections
- preferably have a circular internal cross section, or with a ratio of the sides of less than 1.5
- terminate at roof level with a proper chimney pot: the flue may not discharge directly from the wall or into an enclosed space, even if the space in question is open to the sky
- be made of material rated fire reaction class A1 per UNI EN 13501 or analogous national regulations.
- be certified, with a chimney plate if metal
- be of uniform cross section or vary in cross section only immediately after the outlet, not at some mid point of its length

THE FUMES DUCT

Further to the general prescriptions for the fumes duct and flue, the fumes duct:

- may not be made of flexible metal material
- must be insulated, if routed through unheated areas or outdoors
- must not be routed through rooms in which the installation of combustion heat generators is prohibited, or subject to fire hazard, or which cannot be inspected.
- must enable the recovery of soot and be open for inspection
- must have at most 3 bends, through an angle of no more than 90°
- must have a single horizontal section of length no more than 3 metri, depending on the draw. Note in any case that long sections promote the accumulation of dirt and are harder to keep clean.

THE FLUE:

Further to the general prescriptions for the fumes duct and flue, the flue:

- must serve solely to exhaust fumes
- must be correctly sized to satisfy the requirements of fumes exhaust (EN 13384-1)
- should preferably be insulated, in steel with a circular internal section. If rectangular, the corners must have a radius of not less than 20 mm, with a ratio of the internal dimensions of <1.5
- must normally be at least 1.5 metres in vertical length
- must have a constant cross section
- must be waterproof and thermally insulated to ensure a good draw
- must preferable have a collection chamber for
- If pre-existing, must be clean, to prevent the fire hazard.
- in general, we recommend fitting a tube inside the existing masonry chimney if its diameter is greater than 150 mm.

INTUBATED SYSTEM:

Further to the general prescriptions for the fumes duct and flue, the intubated system:

- must operate in negative pressure;
- must be open to inspection
- must observe local regulations.

THE CHIMNEY POT

- must be windproof
- must have an internal cross section equivalent to that of the flue and a fumes outlet at least double that of the interior of the flue
- for dual flues (which should be spaced at least 2 m apart) the chimney pot receiving the fumes from the solid fuel appliance or that from the higher storey, must be at least 50 cm higher than the other
- it must extend beyond the back flow zone (in Italy, refer to UNI 10683 point 6.5.8.)
- it must allow for maintenance of the chimney

EXTERNAL AIR INTAKE

In general, we suggest two ways to ensure a proper flow of combustion air.

Air intake without direct connection to the appliance

Install an intake at floor level with effective area (net of the mesh or other protective equipment) of at least 80 cm² (10 cm dia.).

To prevent draughts, we recommend installing the intake behind the fireplace or behind a radiator.

Installing it in front of the appliance will create unpleasant draughts.

Air intake with direct connection to the appliance

Install an air intake of effective area (net of the mesh or other protective equipment) at least equal to that of the air intake at the back of the product.

Connect the air intake to the appliance's air intake with a tube (which may also be flexible). Increase the diameter of the pipe if it is not smooth: assess its load loss.

We recommend not exceeding a 1 m length and curving the tube at most one time, depending on the draw of the flue.

The air may be drawn from an adjacent room only if:

- the flow is taken from permanent and unobstructed openings communicating with the outdoors;
- the adjacent room is never in underpressure relative to the outdoors;
- the adjacent room is not a garage, subject to fire hazard, a bathroom or bedroom
- the adjacent room is not a shared room in the condominium

In Italy, UNI 10683 provides that ventilation is sufficient even if a pressure difference between the outdoors and indoors of no more than 4 PA is guaranteed (UNI EN 13384-1). The installer who issues the declaration of conformity is responsible for ensuring these conditions.

VENTILATION AIR EXCHANGE

In addition to the combustion air inlet (which must draw air from the outside as described above), and the booster vents, an opening at least 10x10 cm in size must be made for the ventilation air exchange. This hole should be made in the cover.

ELECTRICAL AND AUXILIARY HOOKUP

The appliance is equipped with an electrical power cord for connection to a 230V 50 Hz socket, preferably with a trip switch.

Variations in voltage of more than 10% can compromise its operation.

The electrical system must be compliant; check the operation of the earth in particular. Edilkamin is not responsible for malfunctions resulting from an improperly grounded system. The power line must be of adequate section for the power of the appliance.

The power cable must not come into contact with the flue or other hot parts of the product.

TERMINAL BOARDS

The right side of the appliance (seen from the front) has a bracket with two terminal boards:

- the upper terminal board (low voltage) has a pre-wired cable for the reset button, while the rest is for use by Edilkamin technicians only
- the lower terminal board (high voltage) is for the electrical power and fan connections;



these connections may be made by a qualified electrician only.
all work must be done with electrical power switched off

upper terminal board (low voltage)

1	2	3	4	5	6	7	8	9	10	11	12
free		clean contact (AUX)		reset button already wired		for Edilkamin technicians only					

lower terminal board (high voltage) VERSIONS WITH FRONTAL VENTILATION (versions 2 and 3)

1	2	3	4	5	6	7	8	9	10	11	12
NOT USED			NOT USED			for front fan kit (Line 7, earth 8, neutral 9)			Pre-wired electrical power connection		

lower terminal board (high voltage) VERSIONS WITH DUCTED VENTILATION (versions 1 and 4)

1	2	3	4	5	6	7	8	9	10	11	12
fan 3 connection (phase, ground, neutral)			fan 2 connection (phase, ground, neutral)			for optional frontal fan kit			Pre-wired electrical power connection		

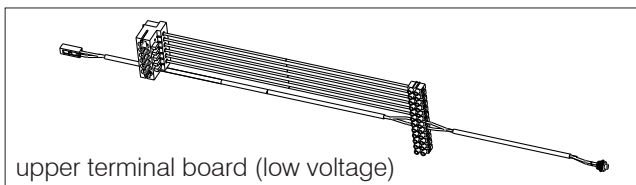

upper terminal board (low voltage)

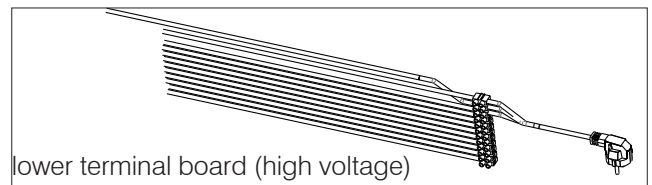

lower terminal board (high voltage)

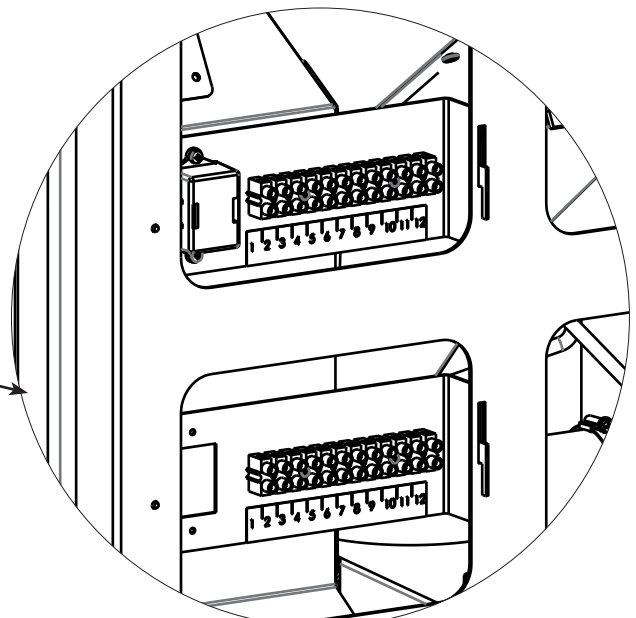
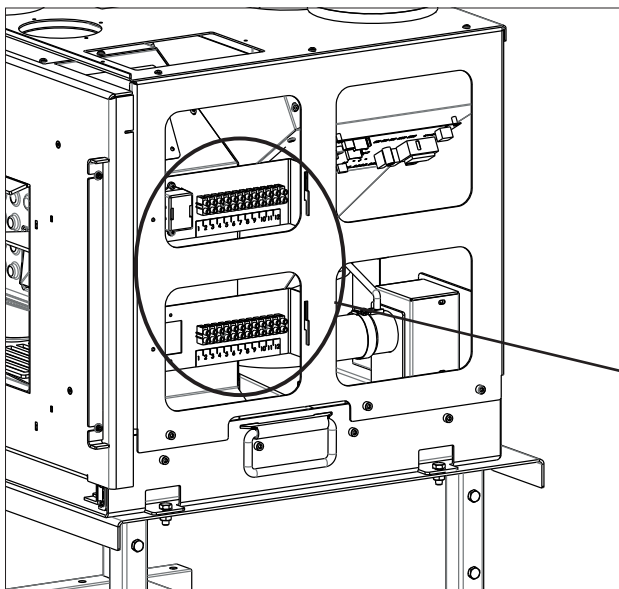

HEIGHT OF APPLIANCE

The Pellkamin can be mounted on an optional stand or any other appropriate support

OPTIONAL BASE

Place the bottom of the base **(1)** in the desired position.

Provide a power socket at the rear of the base, in such a way that the plug is accessible once the installation is complete.

Secure the bottom of the base to the floor with 8 mm steel anchor bolts, to prevent it from tipping over.

Position the top of the base **(2)** and adjust its height with the provided bolts **(3)**.

MOUNTING TO THE BASE

Use the provided screws to secure the appliance to the base



Failure to observe the above instructions can cause the insert to tip over and may result in serious damage and injury.

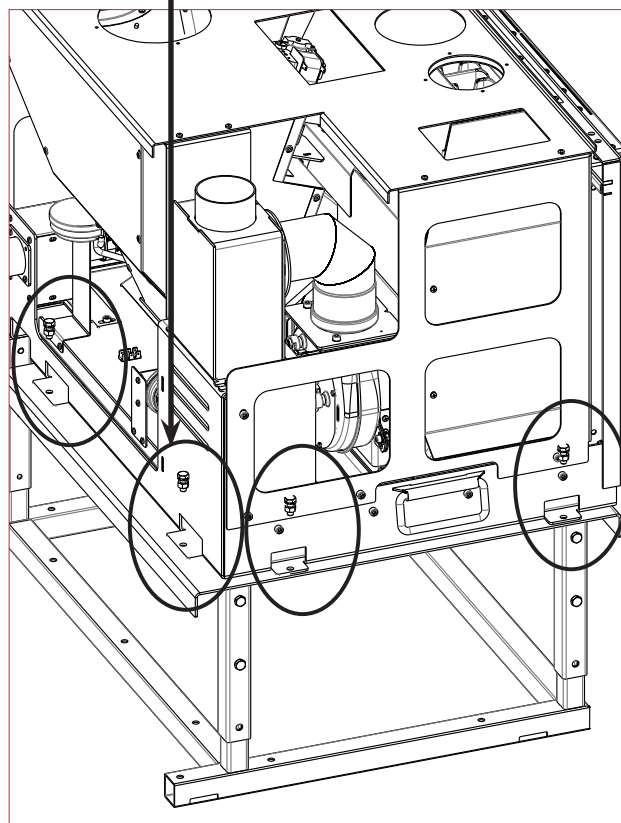
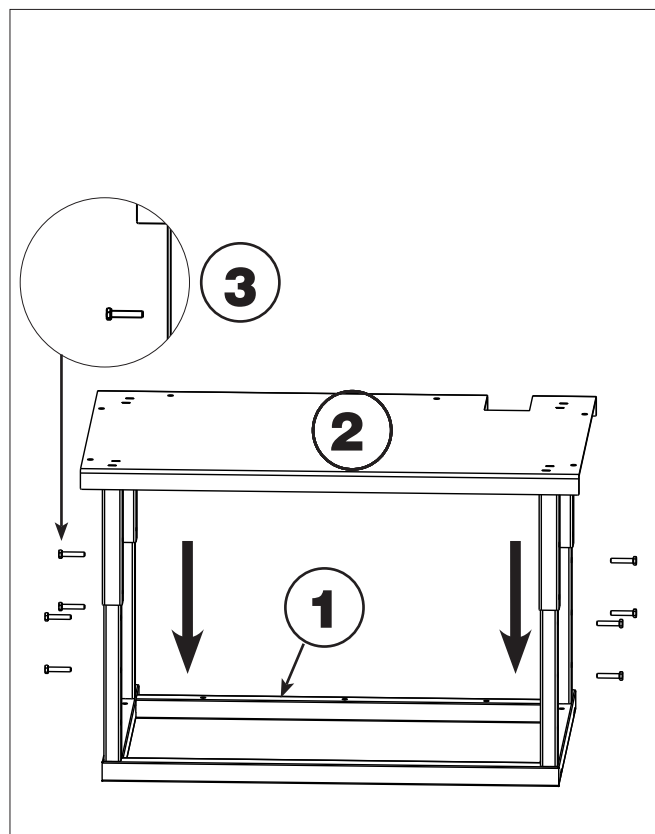
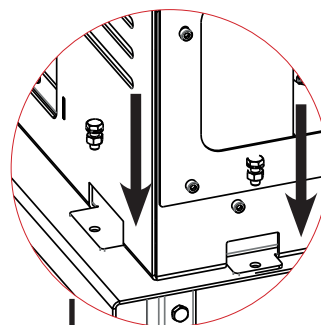
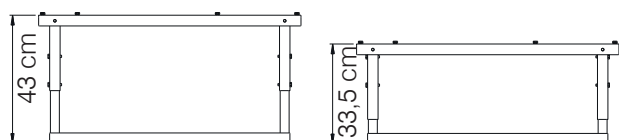

INSTALLING THE LOADING TRAPDOOR

The loading kit includes:

- loading tube
- loading inlet **(A)**, with flange **(B)** for the loading tube **with flap opening**
- small parts

Alternatively, you can install the loading trapdoor:

- at the front
- or on the right side of the mantel.

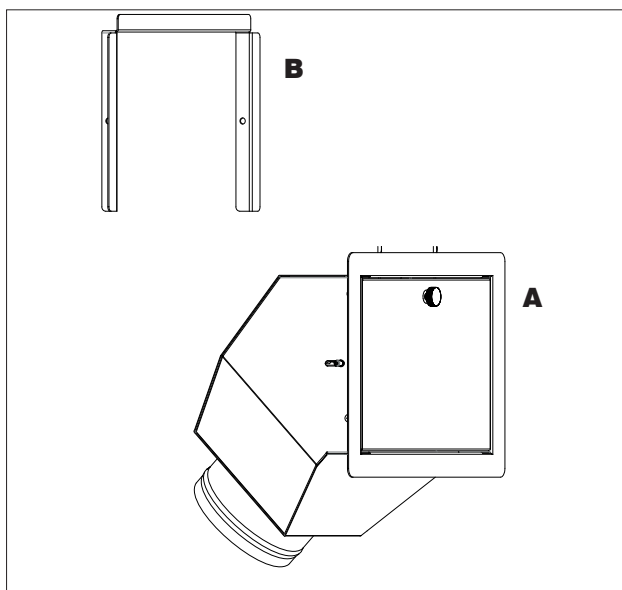
**Step 1: INSTALLING THE LOADING HATCH**

Reinforce the plasterboard with metal profiles at the back.

- Make a hole 31 x 21
- Secure the flange (B) and screw with self-tapping screws with the the plasterboard
- Secure the loading inlet (A). Screw (A) with (B). Open the loading inlet to reach the screws

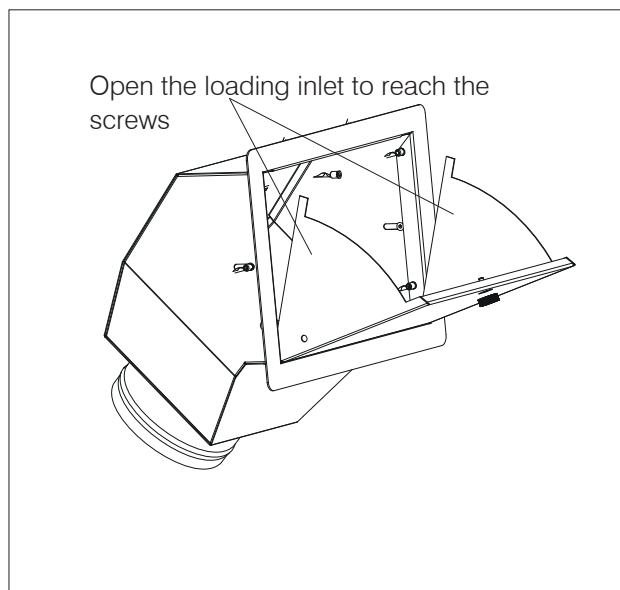

Insulate the loading tube, and make sure that it does not touch the fumes duct



The loading tube must be well extended to facilitate the downward flow of the pellets

Step 2: INSTALLING THE LOADING TUBE

- Secure the flexible tube to the mounting on the loading hatch with the included clamps.
- Cut the tube to length, fit the terminal of the tube to the centring bracket collar, and secure it with the included clamps.

Step 3: COMPLETING THE MANTEL

Before finishing the mantel, load pellets into the tank to check that they slide down without difficulty.

INSTALLATION VENTILATION KIT

Il Kit permette di portare aria calda nel locale di installazione del prodotto o in altri locali col supporto due ventilatori.



**THE PARTS OF THE
MANUAL ON INSTALLATION
ARE FOR THE USE OF
QUALIFIED PERSONNEL**

The kit can be combined with each of the following Edilkamin vents:

- Split, with lighting
- Bent, with lighting
- Origami
- Sharp

The vents are not included in the Air Kit Diffuser and you can choose the one of the four models available and described which best suits your needs at the retailer. The warm ventilation air must be ducted to the outside.

VENTILATION KIT

Contents of the package

Component	Reference in figure	Quantity in the Kit
Ø 10 cm flange to be attached to the product with the 4 screws and clamp provided	(1)	n° 2
Screws bag (details on the facing page)	(2)	n° 1
Ø 80-100 flange bracket as above	(3)	n° 2
Fan Recess Unit, including the fan and two welded flanges (one Ø 10 cm and one Ø 6)	(4)	n° 2
Ø 10 cm aluminium pipe extendible to 1.5 m for connection from the fire-box to the fan kit	(5)	n° 2
Ø 6 cm aluminium pipe extendible to 3 m for connection from the fan kit to the vent (the flanges are incorporated into the fan kit or in one of the vents)	(6)	n° 2
wiring		n° 1

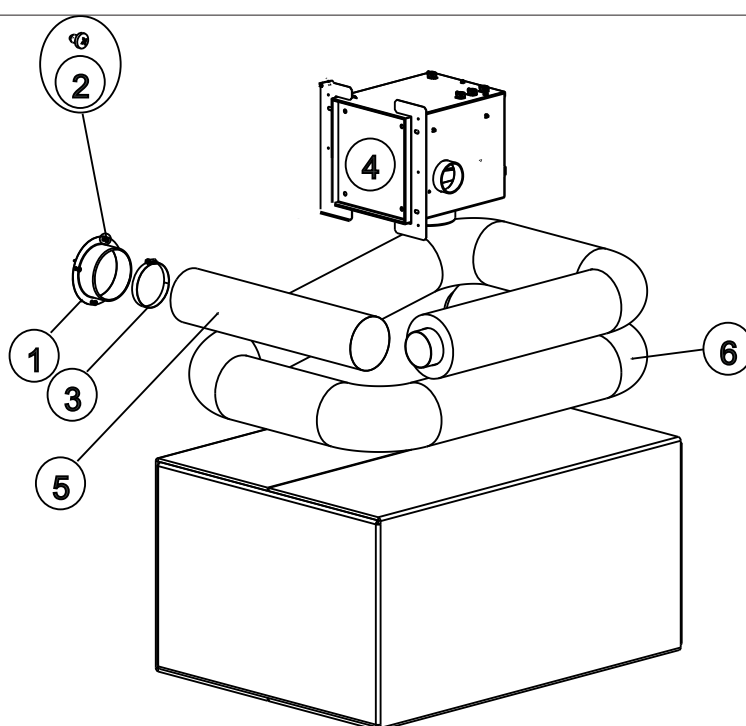

INSTALLATION VENTILATION KIT

1. position the fan kit **(A)** after rotating it by 180° if it is to be positioned to the left of the product, if necessary;
2. Position the vent/s (B) (not provided with the product) or provide other outlets for the warm air pipe;
3. connect the Ø 100 mm pipe * **(C)** from the product to the fan kit
4. connect the Ø 60 mm pipe **(D)** from the fan kit to the vent, .
5. make the electrical connections.

Please see the picture of an exemple with pellet loading hatch **(E)** and vent Label **(F)**

NOTES

- the Ø 100 mm connection section between the product and the fan is a maximum 1.5 m. in length.
- Position the fan low down, preferably close to the base of the appliance, This prevents the heat from ruining the fan. It can also be placed above the appliance, so long as there is no danger of over-heating.
- The maximum recommended ducting length (Ø 60 mm pipe) is 8 m.



* Please INSULATE the Ø 100 mm PIPE FROM the PRODUCT to the FAN KIT



The instructions for installing the vents are included with the vents themselves

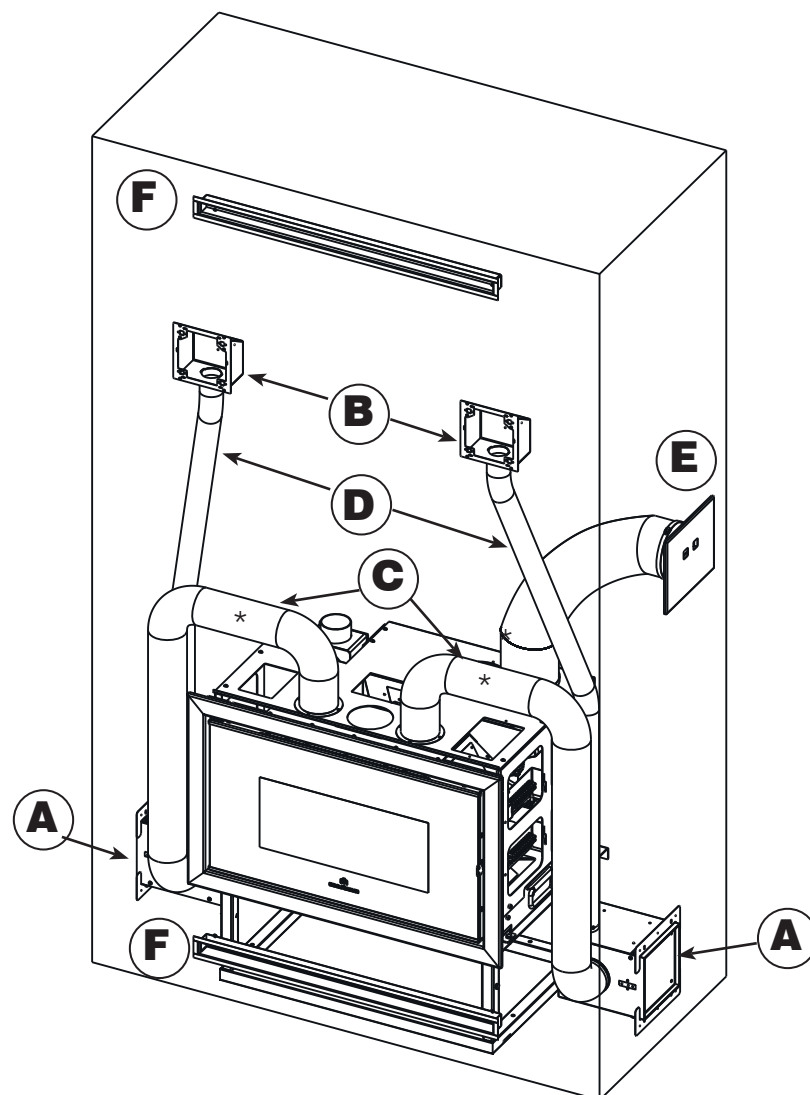

POSITION OF THE FAN IN THE KIT

This is a standard fan with upper vent and ready for use to the right of the product.

If you want to position it to the left of the product, the installer must rotate it by 180 °C.

Summary of the operations shown in the diagram below (fig. 7):

1. press down to open the door
2. remove the screws
3. remove the cover panel
4. rotate the fan, taking care with the cables to be extracted
5. reinsert the fan
6. repeat the operations to reattach the door and rotate the box.

Positioning of the Fan Kit.

Prepare a hole (H190 x L200) on the wall to house the fan kit.

Insert the kit from the inside, then tighten the screws to attach it, leaving the covering open.

To hook the fans up to the controller board, refer to the paragraph above



Only work on electrical parts when disconnected from the electrical power source.

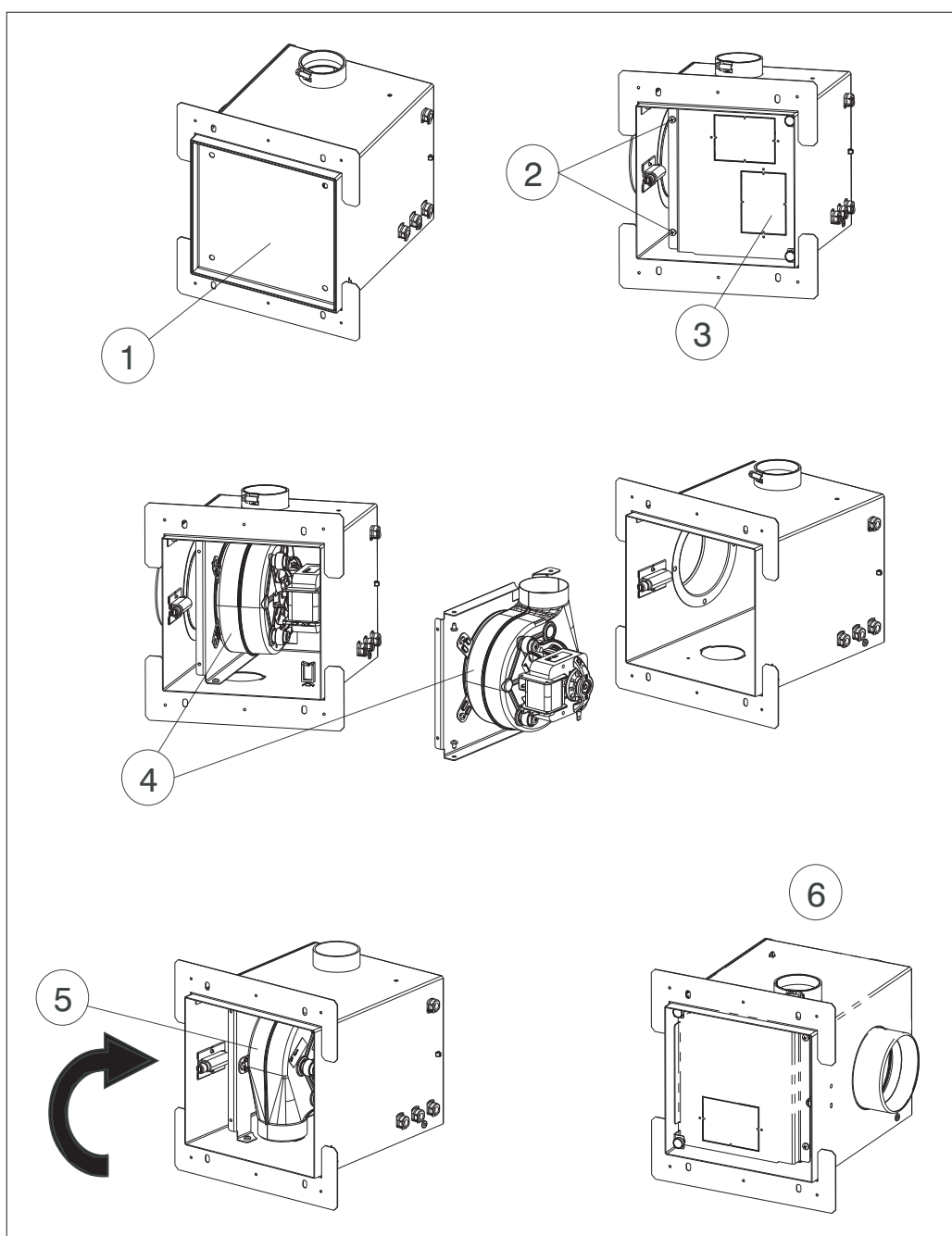

CONTENTS

- Pre-assembled frontal ventilation kit (2)
- snap fitted grille and ceramic assembly (3)
- top front panel of frontal closure

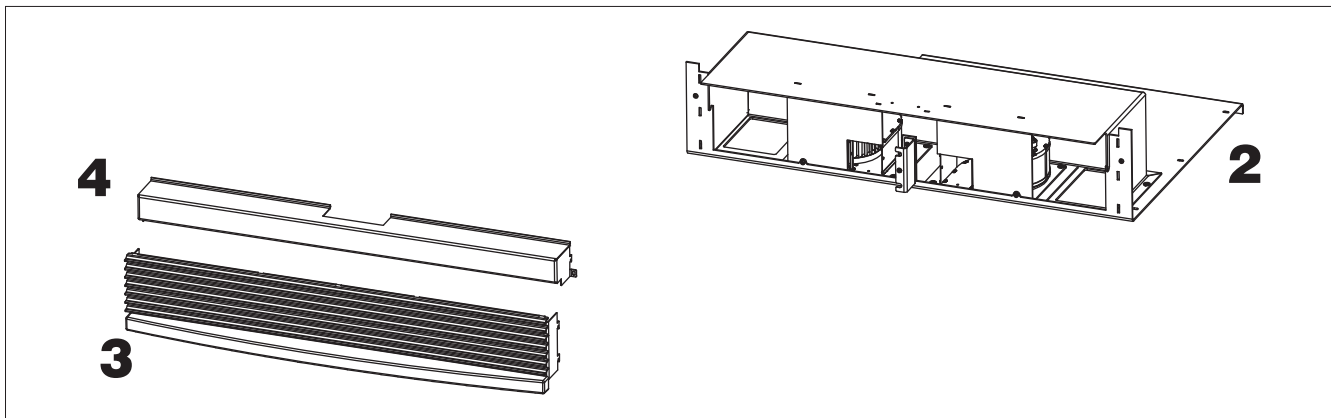
**ASSEMBLY INSTRUCTIONS**

1. unscrew the metal cover on the top part of the frame (1)
2. replace the metal cover (1) which will no longer be used with the pre-assembled Kit (2), and screw it on to the sides
3. electrically connect the fan to the circuit board as shown on the high-voltage terminal board to the side (poles 7,8,9, Line, Earth, Neutral respectively)
4. position the snap fitted grille and ceramic assembly (3) and secure it frontally with the self-tapping screw provided
5. position the top front panel of the frontal closure (4) and screw it on with one screw per side
6. the fan must then be activated by an Edilkamin Assistance Centre, using the reserved settings menu.

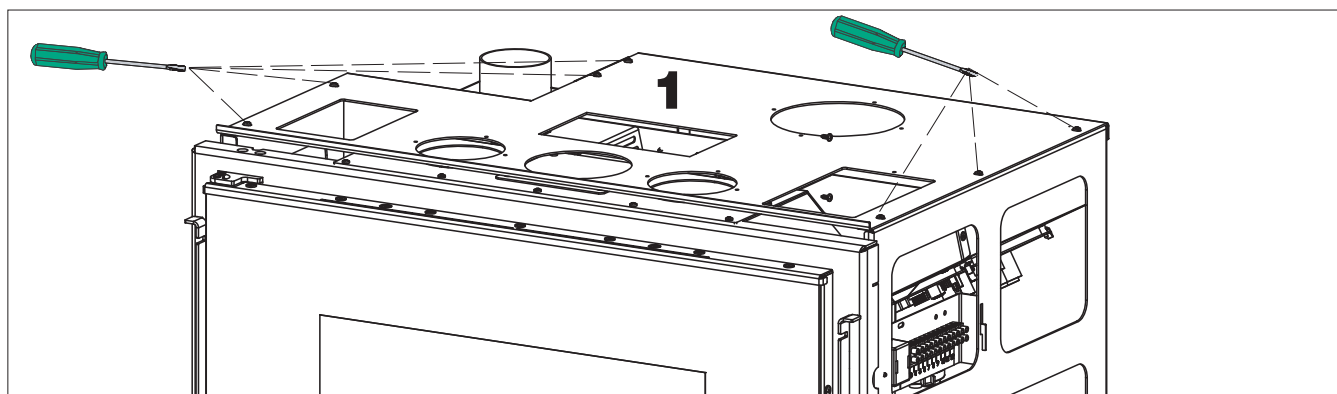

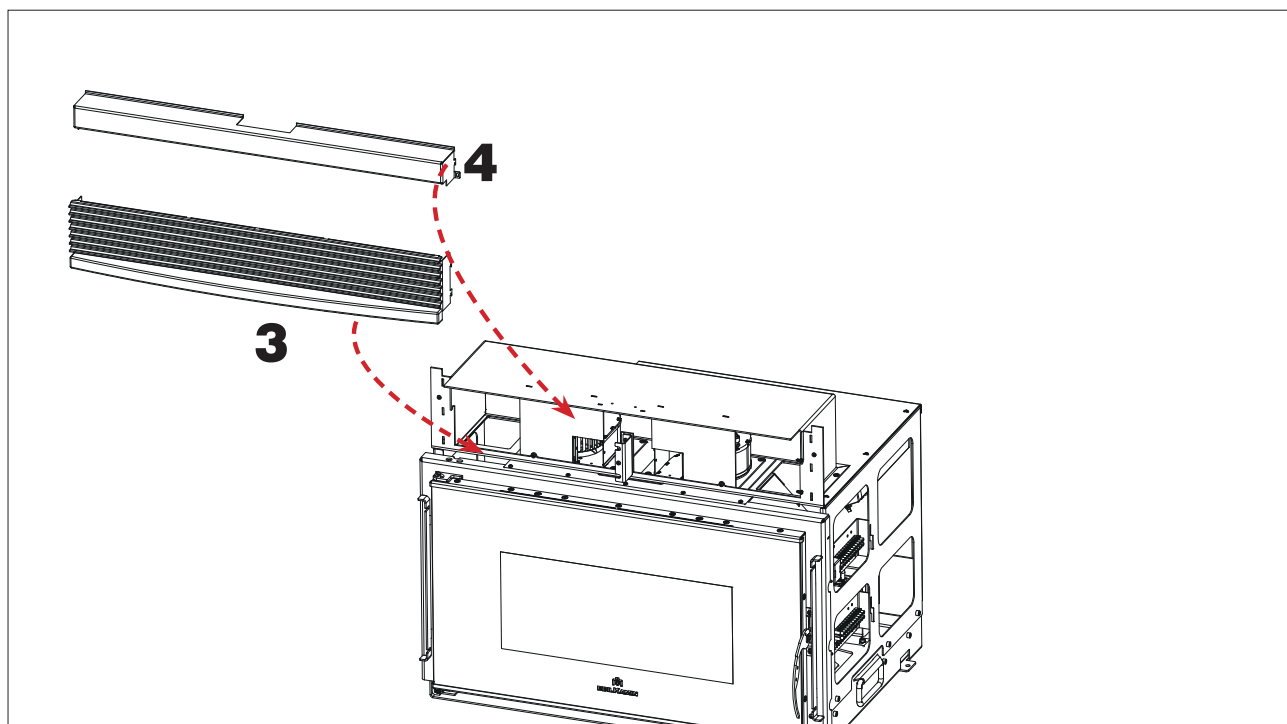
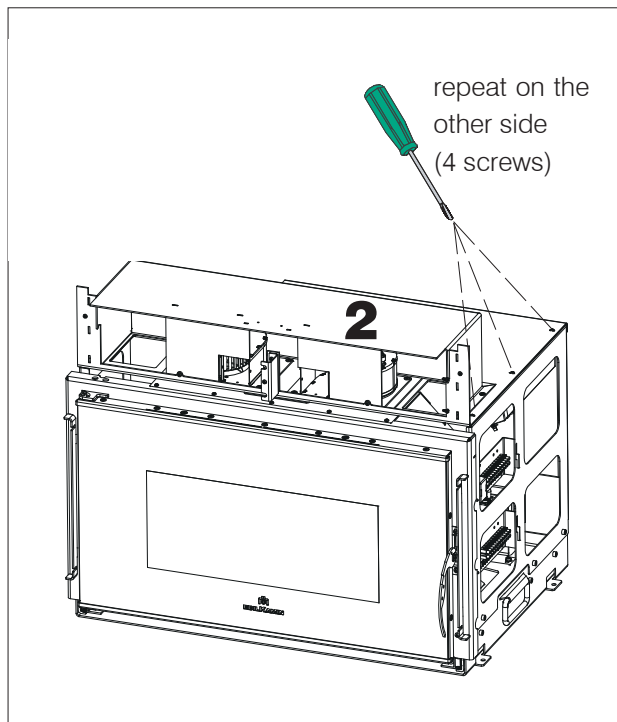
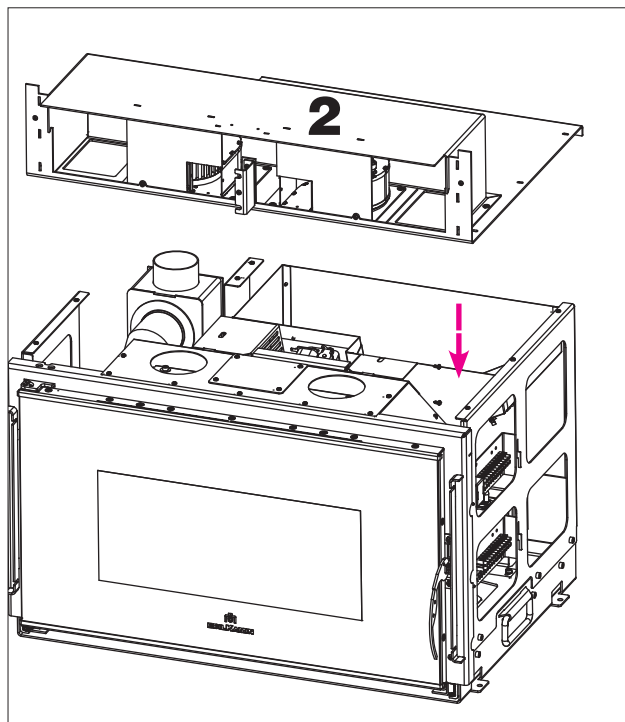

Result with kit installed

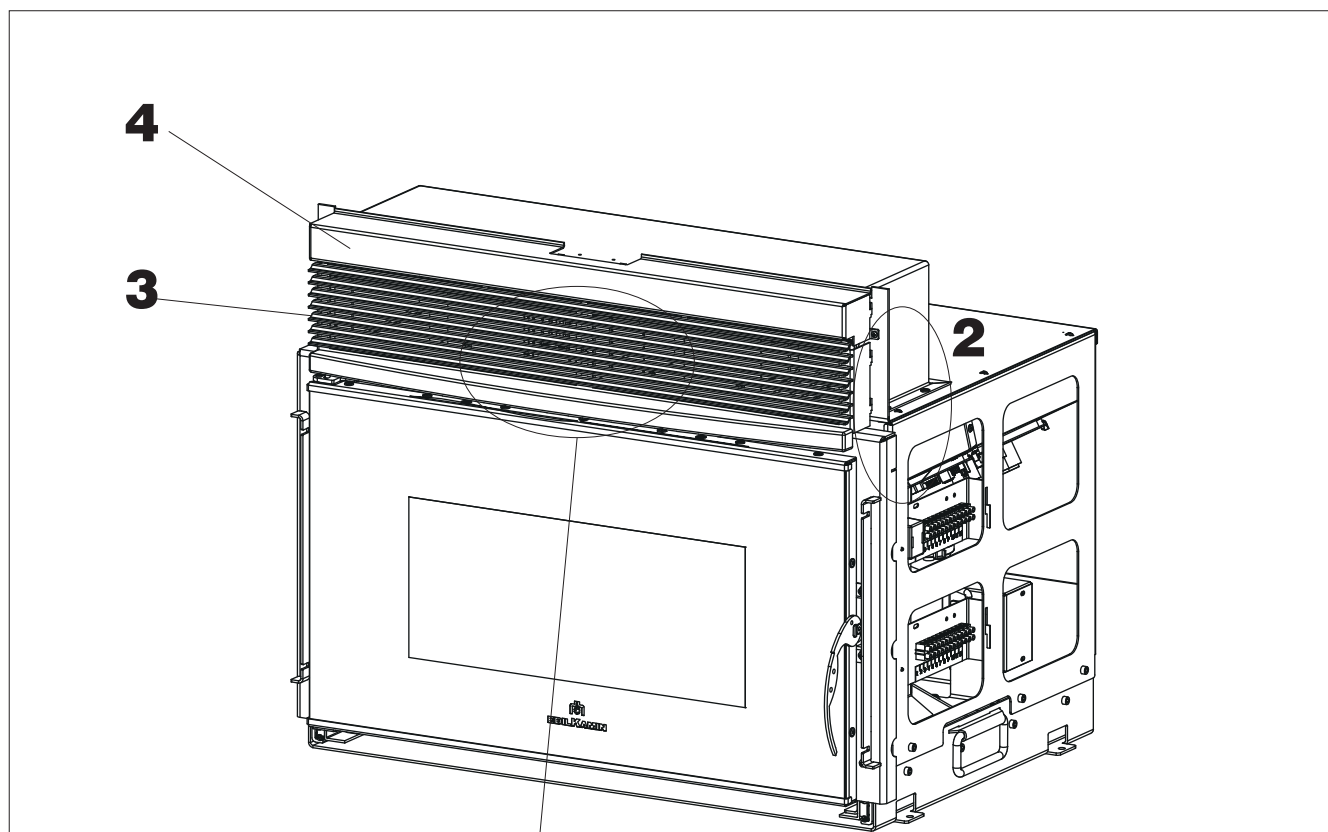

Self-tapping screw
for fixing the grille and
ceramic assembly

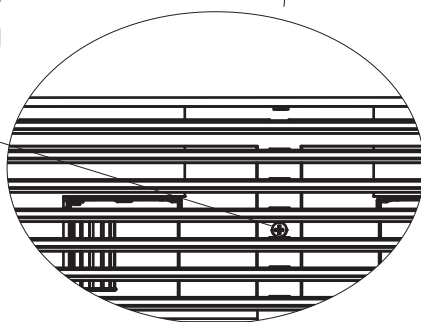

Screw for
fastening the top
front panel of the
frontal closure (4)

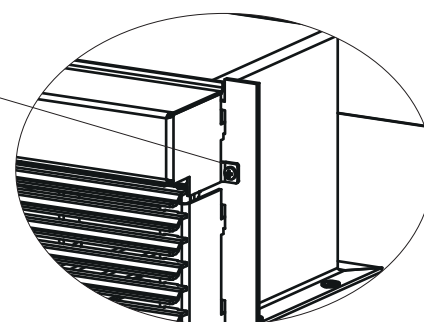

To ensure correct operation, it is essential that the technician adjusts the parameters according to the type of installation (also ducting or not), during the first ignition.

The ventilation will not function properly if the technician does not adjust the parameters.

CONTENTS

- Drawer Kit (2)
- ceramic front panel with support (3)

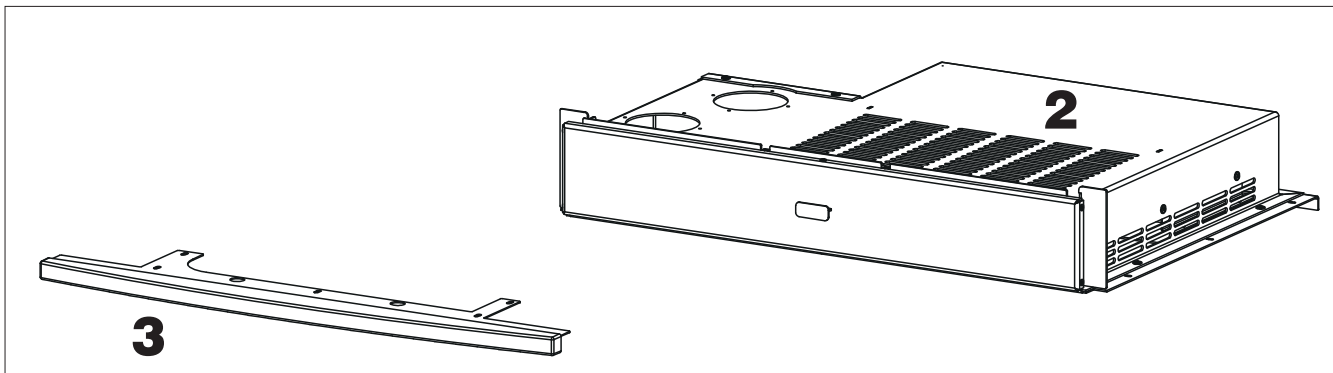

ASSEMBLY INSTRUCTIONS

1. unscrew the metal cover (1) on the top part of the frame
2. screw the ceramic front panel to the frame with its support (3). There are 5 screws in all (two on each side and one in the centre)
3. replace the metal cover with the drawer Kit (2), and screw it on the sides

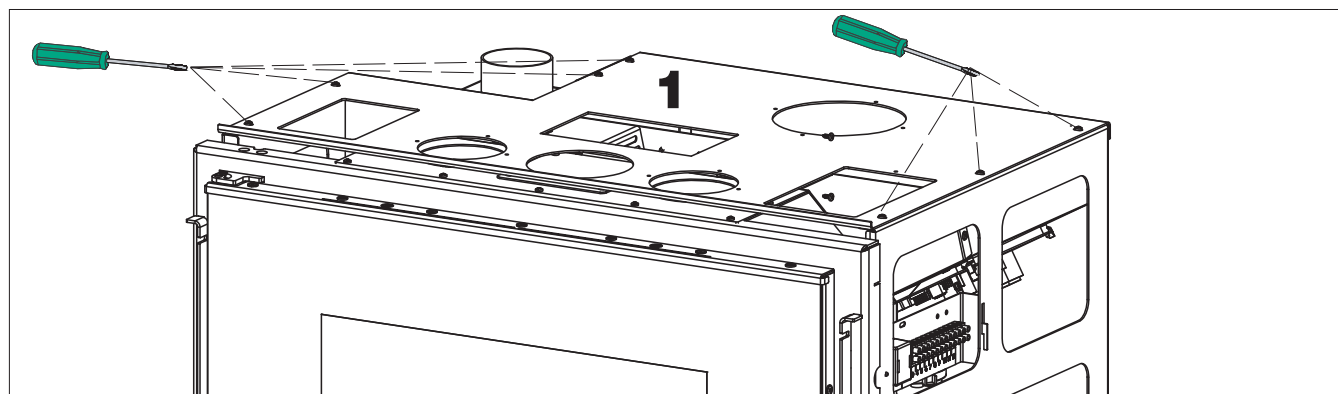

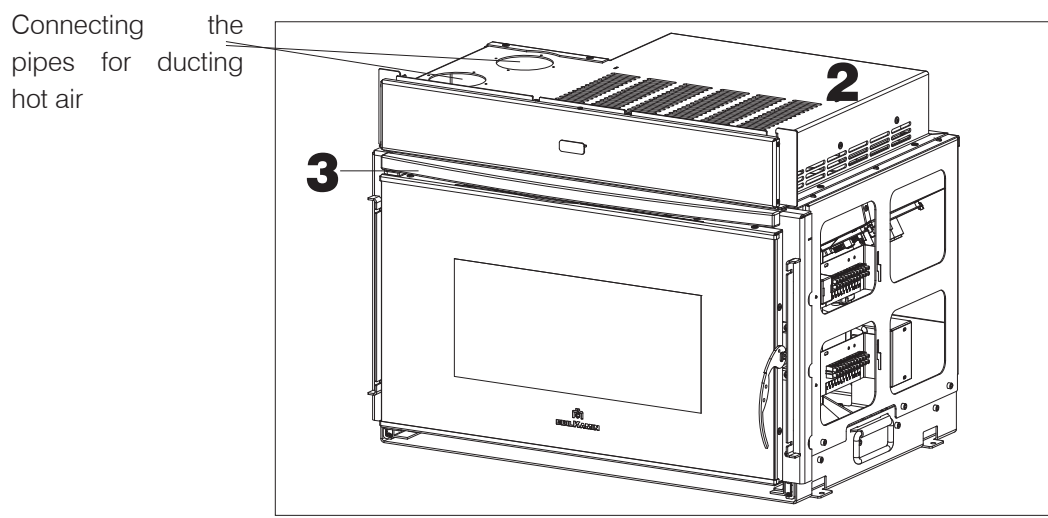
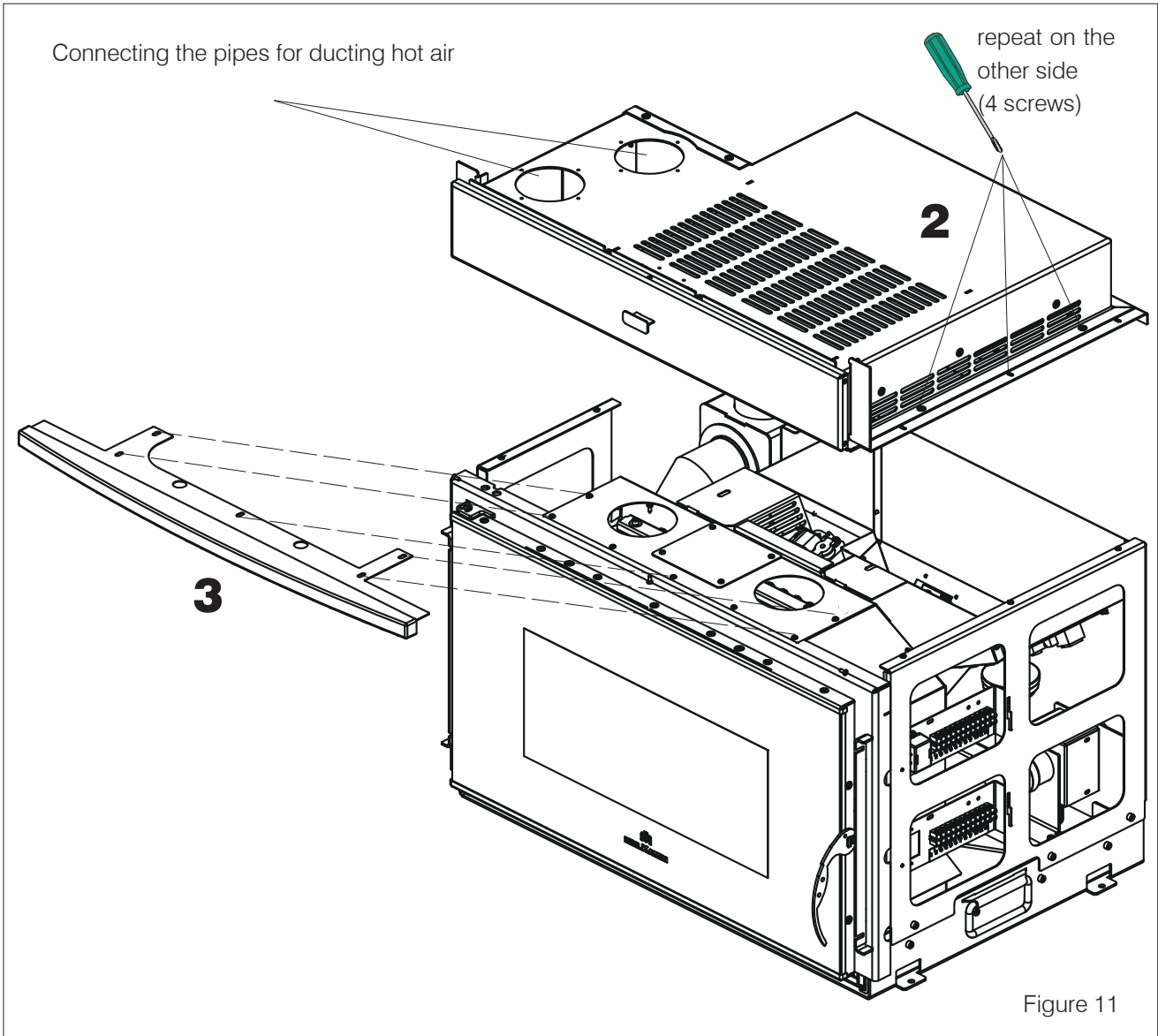

Drawer fitted
Figure 12

ASSEMBLY INSTRUCTIONS

1. unscrew the metal cover on the top part of the frame
2. replace the metal cover with the pre-assembled Kit (1), and screw it on the sides
3. electrically connect the fan to the circuit board as shown on the high-voltage terminal board to the side (poles 7,8,9, Line, Earth, Neutral respectively)
4. position the snap fitted grille and ceramic assembly and secure it frontally with the self-tapping screw provided
5. the fan must then be activated by an Edilkamin Assistance Centre, using the reserved settings menu.

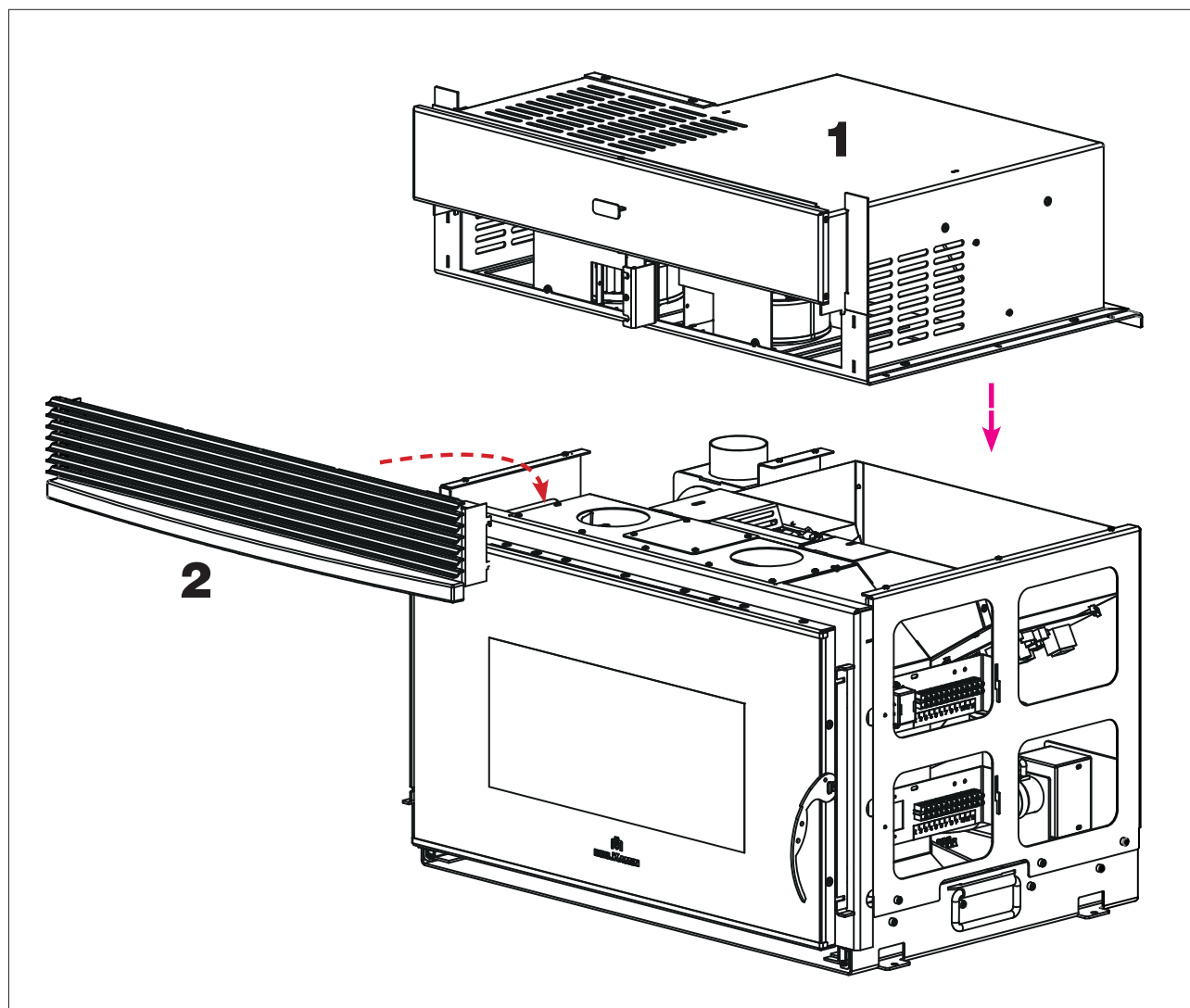

Result with kit installed

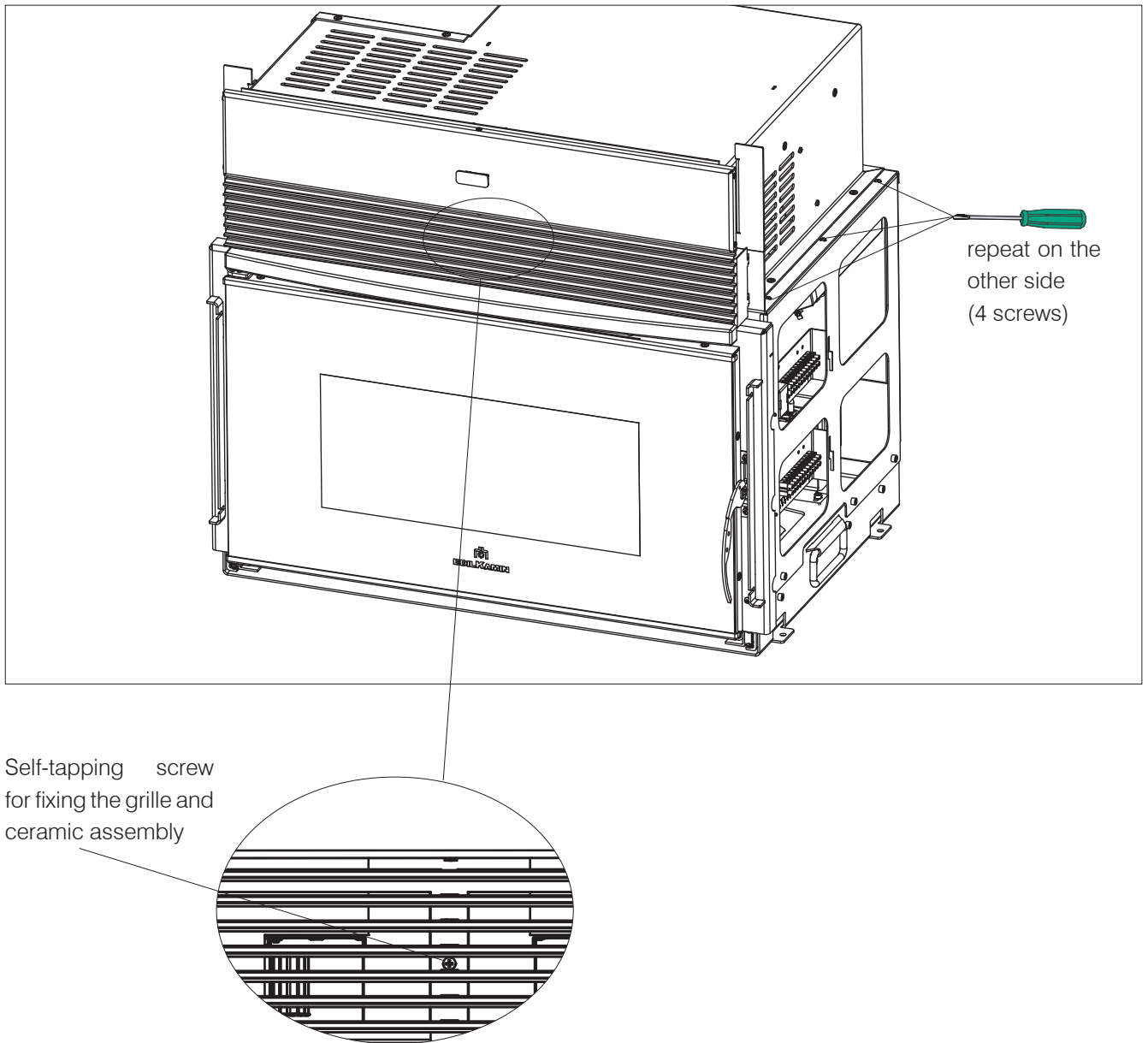

To ensure correct operation, it is essential that the technician adjusts the parameters according to the type of installation (also ducting or not), during the first ignition.

The ventilation will not function properly if the technician does not adjust the parameters.

**INSTALLING THE CLADDING -
PRECAUTIONS**

Regardless of the type of cladding (whether pre-existing or new) make sure that:

- the compensation vents are present so that the mantel does not accumulate heat and damage the ventilation kit;
- an additional opening of at least 10x10 cm in size is available in one side of the cover for ventilation air recovery;
- any wooden beams are insulated and not resting against the metal structure.

WE RECOMMEND THAT YOU TRY USING THE APPLIANCE BEFORE COMPLETING THE CLADDING.

The compensation vents (Label model) included with the appliance must be installed at the front, one at the top and one at the bottom of the cladding.

INLET SURROUND

The inlet surround is used to fill the gap remaining between the fireplace frame and the cladding.

The surround has an opening on one long side. We recommend installing the surround - which is purely decorative - with the opening facing upwards.

To mount it (Figure 16 below):

- insert the surround on to its supports
- secure it with the four grub screws included
- for the side versions, fasten it to the bracket with a nut (D)

For versions

2. with frontal ventilation and pellet loading trapdoor (see fitting frontal ventilation Kit)
3. with frontal ventilation and pellet loading trapdoor (see fitting frontal ventilation and drawer Kit)
4. with ducted ventilation and pellet loading drawer (see fitting Drawer and Ducted Ventilation Kit)

Before installing the surround you have to screw on one fixing bracket.

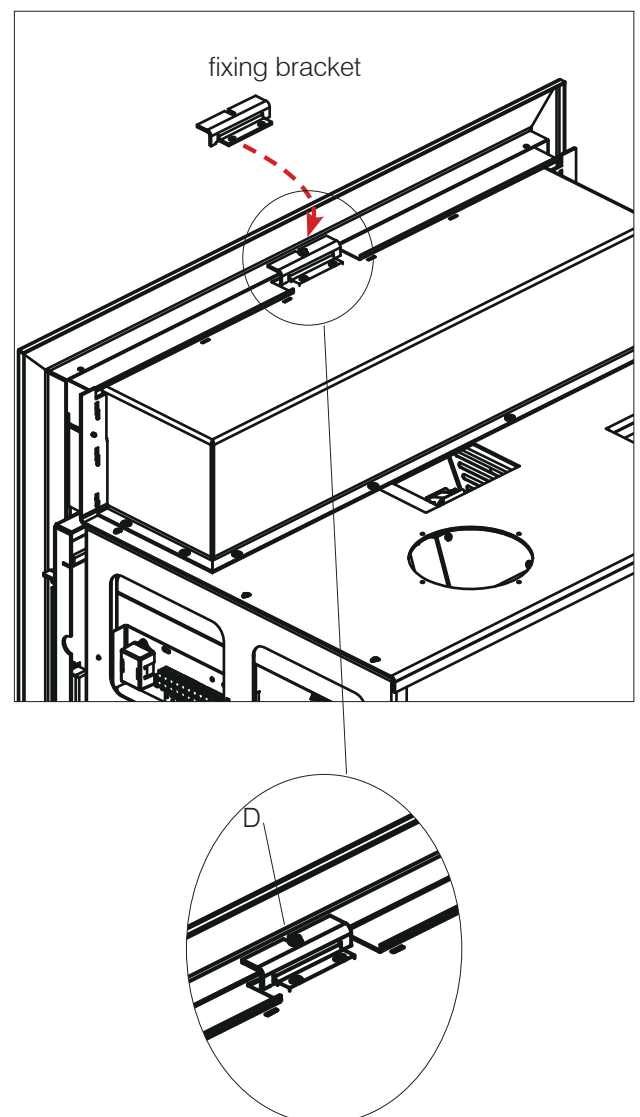
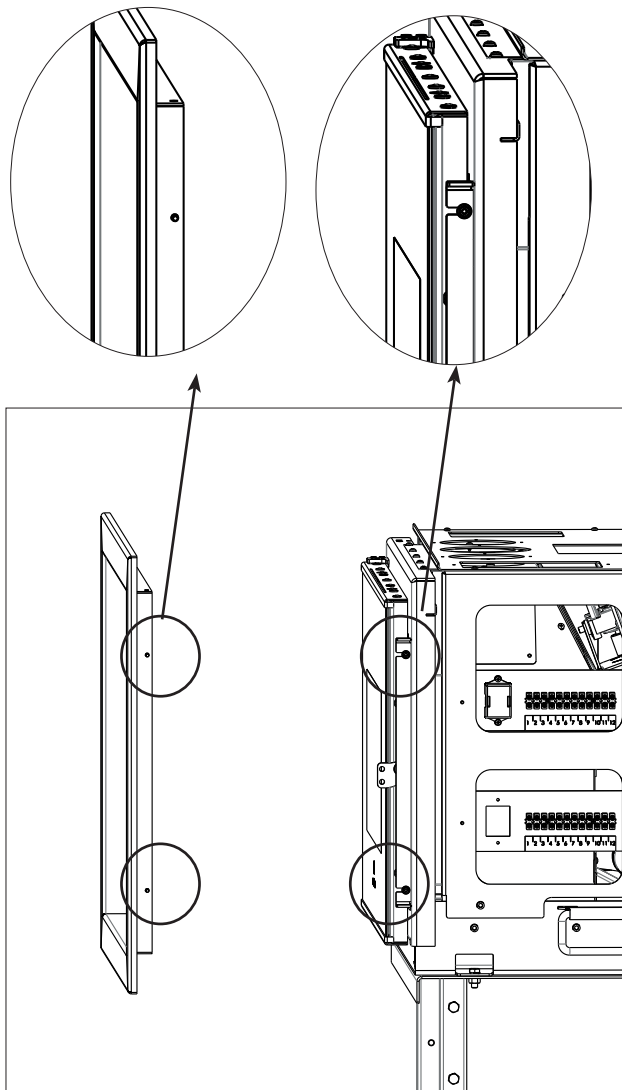

FIRST IGNITION (COMMISSIONING) PHASES

- Make sure you have read and understood this manual
- Remove all flammable materials from the appliance (manuals, labels, etc.). In particular remove any labels from the glass.



On first ignition, there may be a slight smell of paint, which will disappear in a short time.

FUEL

Use UNI EN ISO 17225-2 category A1 wood pellets or similar regulatory products with the following characteristics.

diameter 6 mm

length 3-4 cm

humidity < 10 %

For reasons of safety and environmental compatibility, DO NOT burn plastic, painted wood, coal, bark or other such materials in the stove.

Do not use the product as an incinerator.



Caution

Using fuels other than those specified can damage the appliance

OPENING THE DOOR WITH THE LEVER

To open the door (for regular cleaning and first time) use the appropriate lever (removable handle)

See figure 15.

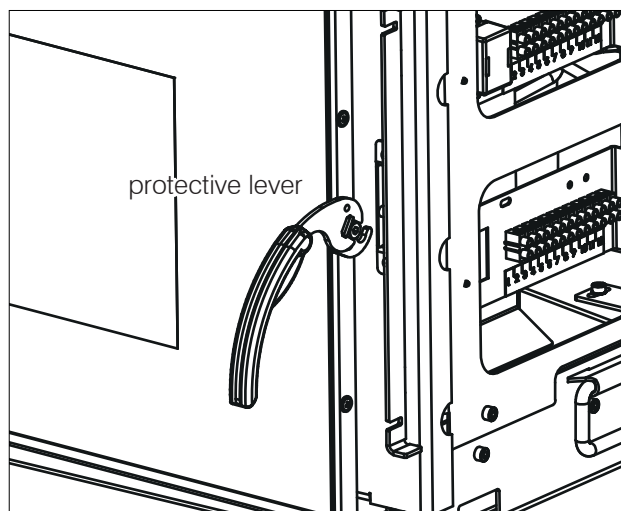

LOADING THE PELLETS INTO THE PELLET TANK

Depending on the version, you can load the pellets:

- via the trapdoor
- via the front drawer

Load the pellets by removing the frontal drawer.

Use the glove when the appliance is hot. The pellets can be loaded even when the fire is burning.

OPERATION

Description. The access to and adjustment of these functions is described below:

Mode	Size settings
MANUAL	<ul style="list-style-type: none"> power level ventilation level
AUTOMATIC	<ul style="list-style-type: none"> desired room temperature ventilation level
PROGRAM-CRONO	<ul style="list-style-type: none"> desired room temperature, selected per day of the week ventilation level

The product also has the following supplementary functions.

Function	In which mode it can be activated	What it does
STAND BY	automatic crono	when the desired temperature is reached, the product shuts off and turns on again when the temperature drops
RELAX	manual automatic crono	enables natural convection mode (fan off), thus reducing the power
NIGHT	manual automatic	allows you to set the fireplace to go out after a given number of hours

OPTIONAL CONNECTIONS

The technician can supply, on request:
external thermostat, phone dialler to be connected to clean contact (AUX) on the terminal board.

PHASES

Further to the above operational procedures, the product has the following phases

- Ignition (display reads ON) Flame ignites and grows stable

This is the result of:

- manual ignition with ignition button
- request from Crono
- power request during stand by
- request from external contact

Ignition has a variable duration, with the aim of reaching the start temperature

- Switch-off (display reads OFF)

The flame is extinguished and the fireplace cools down.

This is the result of:

- manual switch-off with switch-off button
- power demand ceases with Stand by function active
- request from Crono
- request from external contact

Switch-off has a variable duration, with the aim of reaching the stop temperature

- Shutdown

Switches the fireplace off in response to an alarm

In case of malfunction, a key is available for switching the fireplace on and off and setting the temperature (without visual indication except for the flame itself)

INTERFACE

The user interface is the remote control but, if this is not available, you can control the product with the button on the loading hatch

1. WITH THE PRODUCT OFF
press the button for 2" to turn the fireplace on.
2. WITH THE PRODUCT ON
press the button for 2" to turn the fireplace off.
3. WITH THE PRODUCT ON IN MANUAL MODE
press the button to increase its output power

REMOTE CONTROL

Specifications:

RF transceiver module, frequency 2.4 GHz - Powered by two AAA 1.5 V batteries rated at least 1200 mAh.

ON/OFF button:

manual on/off button and for switching the remote from energy saving mode to active heating

touch buttons:

+: increment button (increases the fireplace's power, temperature or fan speed, etc., or scrolls through the menu)

-: decrement button (decreases the fireplace's power, temperature or fan speed, etc., or scrolls through the menu)

M: menu key / relax mode key

OK: confirm key, switches to the next setting and between automatic and manual modes

NOTES

- The remote control does not store the programs, which are stored on the logic board; there is thus no need to reprogram it when it is shut off or replaced by a new one.
- The remote exchanges information with the logic board (including room temperature sensing in automatic mode) every 2" and when it is activated by pressing the ON/OFF button.
- In normal use, the remote's batteries should last a year. This is an approximate value, since it depends on both the type of batteries and the intensity of use. Edilkamin and the reseller will not consider claims for battery life under any circumstances. If the battery charge is low, a warning displays at the top left.

REMOTE CONTROL POWER SAVING

If the remote is not used for 20", the display turns off to save power. The display turns black without text. This condition refers solely to the remote itself, and not to the fireplace.

To turn the display back on, press the ON/OFF button.

DO NOT PRESS THE ON/OFF BUTTON REPEATEDLY; this turns the fireplace on and off in manual mode



REMOTE CONTROL FIRST POWER ON

- Open the back of the remote and insert the two batteries in the indicated orientation.
- hooked up electrically
- **THE AUDIBLE SIGNALS PRESS THE ON / OFF BUTTON**

Otherwise it will not work

If this is the first power on and the language has not yet been set, the language selection page will display. Select the language with the +/- keys and confirm it with OK. You are now asked to confirm or set the time and date. Set the values with the +/- keys and confirm with OK. The day of the week is calculated automatically using a perpetual calendar.



SENDING SIGNAL FROM THE REMOTE CONTROL TO THE PRODUCT IS CONFIRMED BY BEEP.

IN ABSENCE OF ANY BEEP, THE PRESSURE ON THE BUTTON WAS TOO SHORT.

The display reads the **POSSIBLE STATES** described below:

- OFF STATE

The fireplace is shutting off or is off in response to operation of the remote control's ON/OFF key or an external contact (crono, phone dialler)

The display shows the current time, room temperature and the status in relation to which the fireplace is OFF.

The fireplace is OFF :

in response manual intervention (fig. 1)

due to power failure (fig. 2)

shut off by Crono mode (fig. 3)

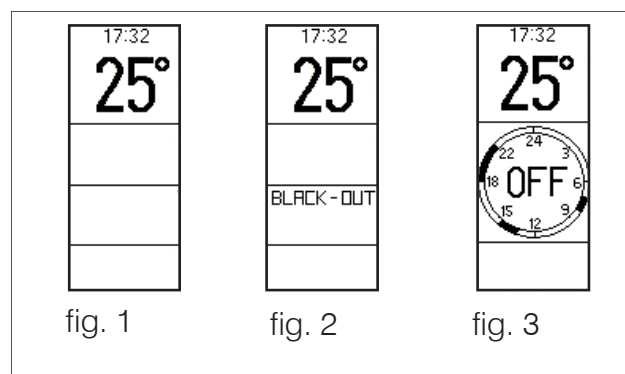

fig. 1

fig. 2

fig. 3

From the OFF page, press the ON/OFF button for 3 seconds to go to the ON page.

Pressing the +/- keys has no effect.

Pressing the M key displays the menu.

- ON STATE

The fireplace is ON.

The display shows (figure 4)

1. the current time
2. the current room temperature
3. the room temperature setting or manual mode
4. the power level (represented by the flames)
5. the fan level (represented by the filling in of the blades)

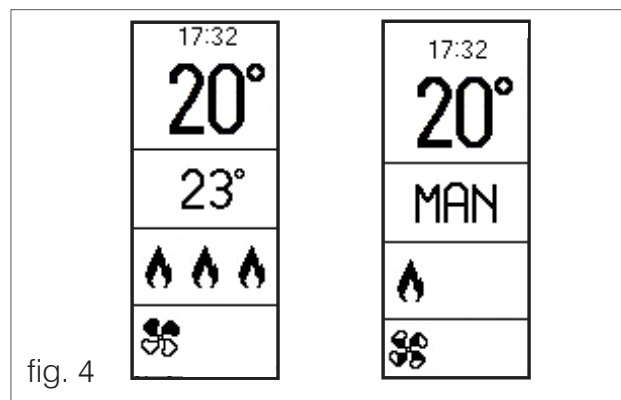

fig. 4

If timer programming is active, 3 and 4 are replaced by the day's timer programming with the current setpoint at the centre (figure 5) and the temperature displayed at the top right.

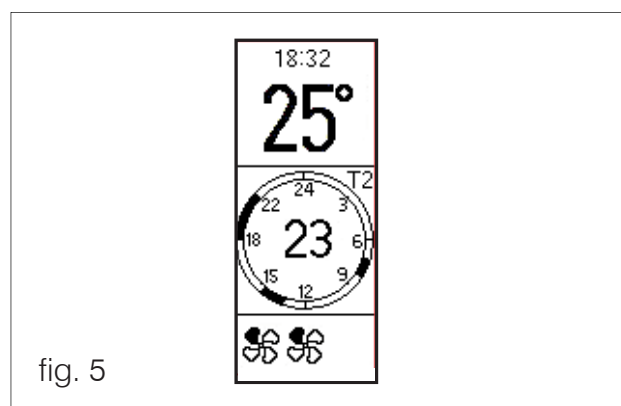

fig. 5

- ALARM STATE

In case of shutdown due to alarm, 4 is replaced by a message indicating the type of shutdown (figure 6)

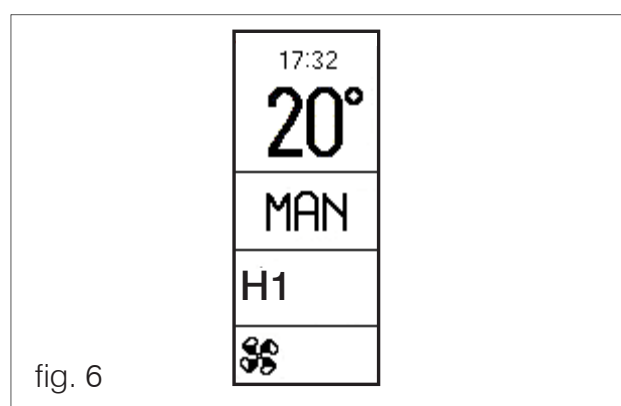

fig. 6

- STAND BY STATE

Situation in which there is no demand for heating.

If the Stand By function is active, the display shows the same information as in the ON state, without flame in the upper left displayed "STB".



When It Is On, The Fireplace Does Not Always Have A Flame. The Fireplace Turns On In Response To The Heating Demand Setting.

USER CONTROLS (REMOTE CONTROL)

- ON/OFF

- Switch-on/switch-off

- Manual mode setting

- Power setting
- Fan setting

- Automatic mode setting

- Temperature setpoint setting
- Fan setting

- RELAX function

- From the **Menu page:**

- **Load Pellets** (SCREW LOAD)
- **Stand By**
- **Crono-Program**
- **Night**
- **Date / time**
- **Display**
- **Language**
- **Beep** (BUZZER)
- **Info** (technician only)
- **Technical menu** (technician only)



We describe the procedures below.

ON/OFF

hold the ON/OFF button down to turn the product ON. When ON, the product has a flame (ignition phase, etc.) when there is a heating demand.

Switch-on/Switch-off

The ON/OFF button switches the product on (starts the ignition phase) or off (starts the switch off phase) manually **in Manual mode only.**

In Automatic mode, the product responds to the heating demand.

Setting Manual/Automatic

Press the OK button for 2 seconds to switch from manual to automatic or vice versa.

In Manual mode, the display reads "Man"

In Automatic mode, the temperature displays.

In automatic- Room Temperature Setting

Set Room Temperature (read by the remote control, this should be positioned in the room the product is installed in)

Set the temperature setpoint (Set) with the "+" and "-" buttons.

In manual- Power setting

Set the power level (displayed by the flame symbol) with the "+" and "-" buttons.

The power level displays next to the flame symbol.

MODELS WITH DUCTED VENTILATION

The Pellkamin is equipped with two fans, defined in the control logic as fan 2 and 3, and displayed as positions 2 and 3 (see below).

The two fans can be adjusted separately. First adjust fan 2 and then fan 3, as described below.

Ventilation setting

Press "OK" once

The fan setting displays, next to the blade symbol representing the fan.

Set the fan level with the "+" and "-" buttons.

The blades fill in to indicate the current setting.

Confirm by pressing the OK button for 2 seconds

The fan settings can also follow the power demand (decrease when the power is decreased or increase vice versa).

To activate this mode, press the + button to above the maximum setting. The letter "A" will appear next to the blade symbol.

To ensure that the speed of the fans varies according to room temperature demand, contact CAT, who will be able to fit dedicated sensors.

In the event of the installation of the optional front fan, fans 2 and 3 will not be present and the Edilkamin technician will explain the new operating mode during installation.

MODELS WITH FRONTAL VENTILATION

Follow the instructions below to manually regulate the power levels of the fan.

Press "OK" once

The fan setting displays, next to the blade symbol representing the fan.

Set the fan level with the "+" and "-" buttons.

The blades fill in to indicate the current setting.

Confirm by pressing the OK button for 2 seconds

The fan setting can also follow the room temperature demand (reduce when the temperature is close to the desired temperature or increase vice versa).

To activate this mode, press the + button to above the maximum fan setting. The letter "A" will appear next to the blade symbol.

THE NUMBER NEXT TO THE FAN BLADE OR FLAME ONLY DISPLAYS WHILE THE SETTING IS BEING MADE.

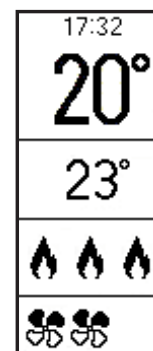

- Relax function

Natural convection function with automatic power limiting.

This function is available in all modes: automatic, manual and crono.

Hold down the “M” button for two seconds to activate the Relax function.

At display appears the symbol in the picture below. 

Hold it down again to deactivate it.

The product reduces its power output and after a few minutes switches the fan off too.

Pressing OK or “+” or “-” in this mode has no effect.

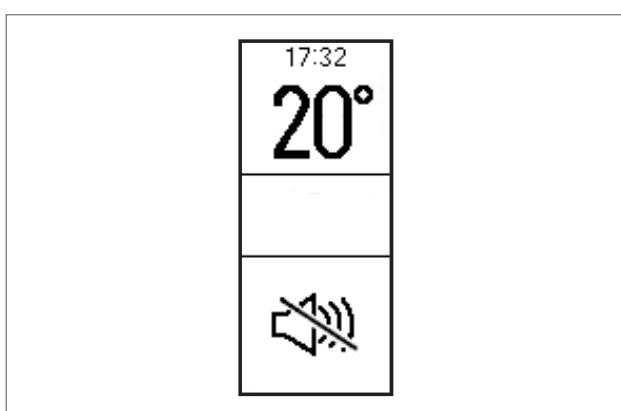

Menu

Press the “M” button to display the menu.

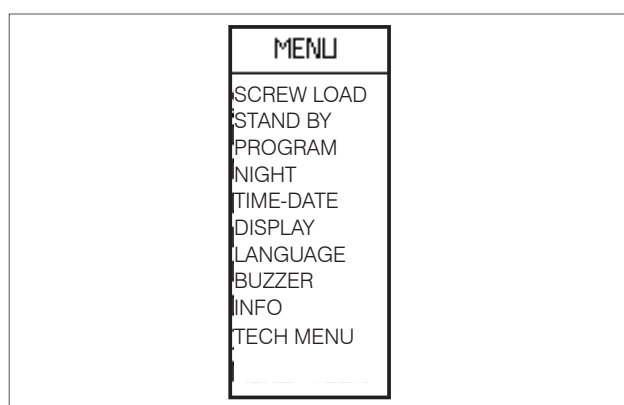

When the menu displays, the buttons have the following functions:

“+” : scroll up

“-” : scroll down

press and release “OK”: enter menu option

press and release “M”: quit menu option

Press the ON/OFF button to confirm and return to the main page.

- Stand by

When the Stand by function is active, in automatic and timer modes, the product shuts off when the temperature setpoint is reached and turns on again when the temperature drops.

When the Stand By function is not active, the product sets itself to minimum power when the temperature setpoint is reached

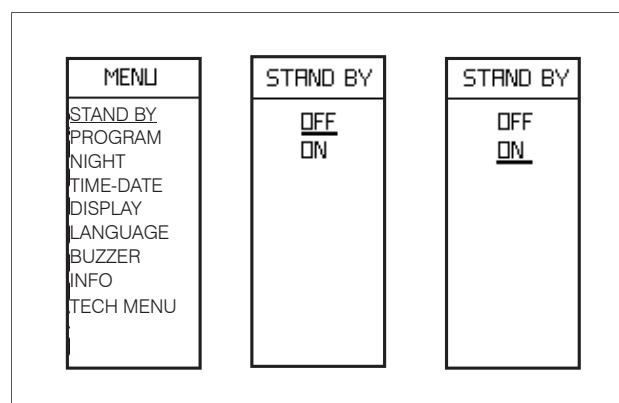

To access the function from the main menu (as indicated in the Menu section above), press the M button. Scroll using the +/- buttons and select the function by pressing OK.

Use the “+/-” buttons to select OFF or ON.

Press “M” to quit without saving.

Press “OK” for two seconds to confirm and return to the previous menu level.

If you selected ON, the display shows the minutes for which the product will continue running at minimum power even when the temperature setpoint has been reached.

Use the “+/-” buttons to increase or decrease this time.

Press the ON/OFF button to confirm and return to the main page.



The fireplace is programmed by default with a delta of +/- 1 °C to optimise comfort. The technician can change this setting during commissioning to suit the needs of the application.

The display shows the temperature rounded down, so that both 20.1°C and 20.9°C display as “20°”

E.g., with the room temperature set to 20° C, the product will enter modulation mode/switch off when a temperature of 21° C is reached and will switch on again below 19° C.

Crono

When the Crono function is active, the user sets a temperature setpoint and a time zone for which that setpoint is specified.

The setting involves different steps, which do not need to be consecutive:

- enabling the Crono mode to 7 days a week or on single days ("ENABLE" on the display);
- setting three temperature setpoints, making sure that T1 is always lower than T2 and T2 lower than T3 ("TEMP" on the display);
- combining one of the three temperatures (T1, T2 or T3) with a time period ("SET" on the display).

Once the settings are complete, you can display/change the time periods and the set temperatures ("CHANGE" on the display).

The ON/OFF button always allows you to return to the main screen.

To enter the Crono function from the main menu, press "M" once from the active display. Scroll down to "Crono" (underlined) using the "+/-" buttons. Press "OK" to confirm and select the Crono function. To go back to the previous screen press the "M" button.

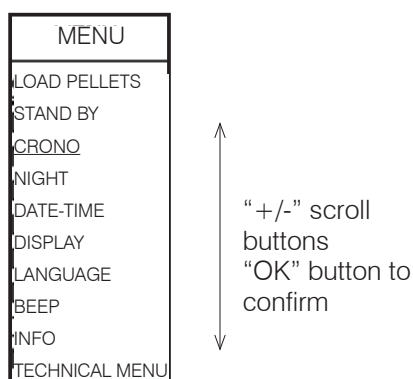

The following screen will appear. Scroll to "ENABLE" (underlined) using the "+/-" buttons.

To enable the Crono function to 7 days a week or on single days ("ENABLE" on the display), press the "OK" button.

To go back to the previous screen press the "M" button.

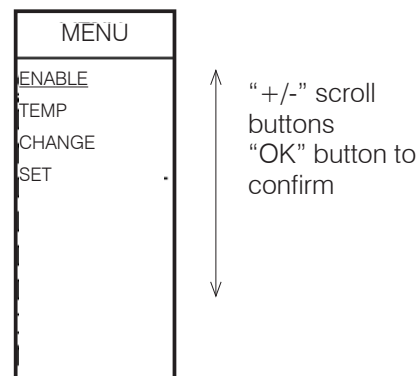

Scroll to the desired position (eg. "7 DAYS", underlined) using the "+/-" buttons.

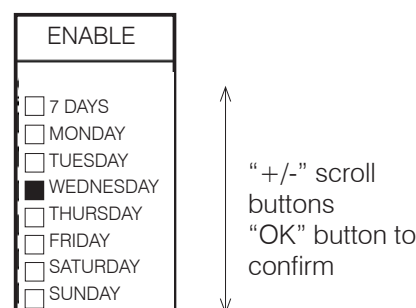

The selected option is identified by a black square on the right, instead of a white one (e.g. on Wednesday if selected).

To continue with other changes, press the "OK" button.

To choose between exit without saving and save, press the "M" button.

The following screen will appear.

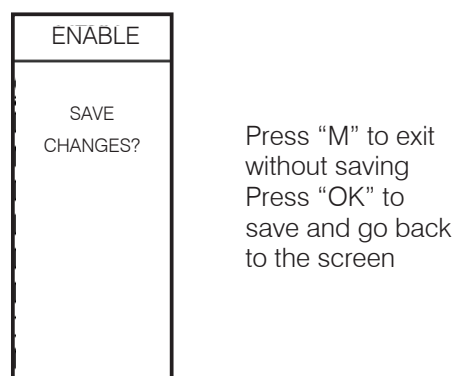

The Crono function is disabled when none of the items is selected.

When the Crono function is disabled, the product operates in automatic mode.

To set the temperature setpoints ("TEMP" on the display), from the Crono function, press the "OK" button. The following screen will appear. Scroll to "TEMP" (underlined) using the "+/-" buttons. Press the "OK" button to confirm and select "TEMP". Press the "M" button to go back to the previous screen. press the "OK" button to enter the "TEMP" function.

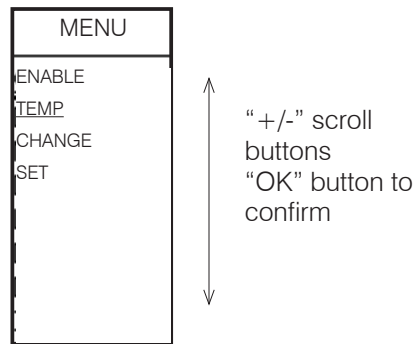

The Crono has three adjustable setpoints: T1, T2 and T3 (screens below).

Press the "OK" button to switch between the setpoints. Use the "+" and "-" buttons to set the desired temperature setpoint for each level.

T1 must always be lower than T2 and T2 lower than T3: if you try to set a T1 temperature that is higher than T2, the T1 temperature will automatically match T2.

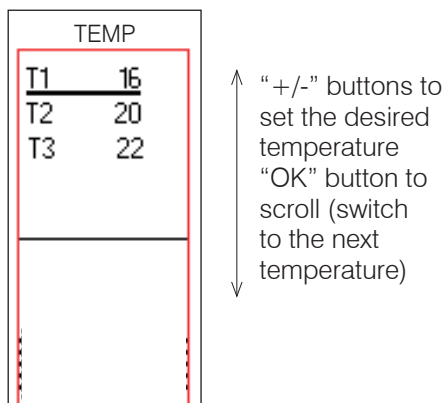

To continue with other changes, press the "OK" button.

To choose between exit without saving and save, press the "M" button.

The following screen will appear.

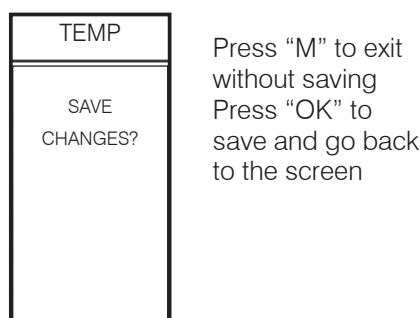

To combine one of the three temperatures to a time period ("SET" on the display), from the Crono function, press the "OK" button. The following screen will appear.

Scroll to "SET" (underlined) using the "+/-" buttons. Press the "OK" button to confirm and select "SET". Press the "M" button to go back to the previous screen. press the "OK" button to enter the "SET" function.

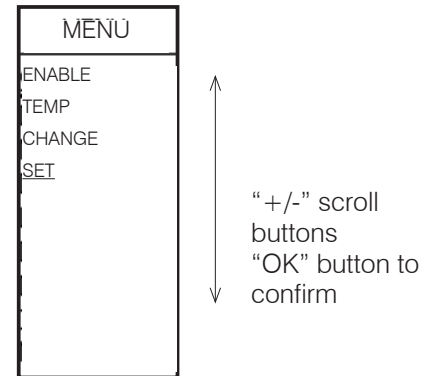

The first page (below) allows you to choose whether to apply the same Crono configuration for 7/7 days, 5/7, weekend only or day by day.

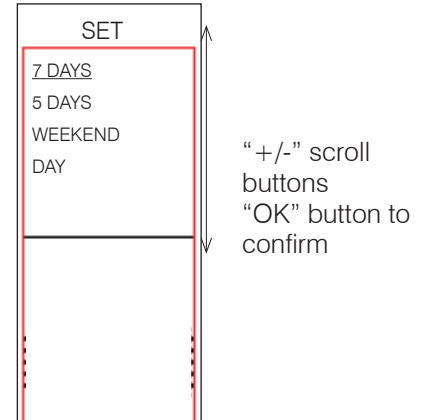

NOTE

Press the O/I key to switch on/off the product, outside setted time periods, when Crono mode is enabled. Crono mode will be disabled.

See instructions on the Crono section to restore the Crono mode.

The second screen (accessible by pressing the "OK" button from the first screen) allows you to set the start and end time of the time period matching the chosen temperature setpoint (T1, T2 and T3).

The set temperature is shown in the middle of the clock.

This is done in steps of 30'. The periods that the appliance is ON are shown with the dots of the numbers in black. The periods shown with the dots of the numbers in white, the appliance is OFF.

The setting screen is the following.

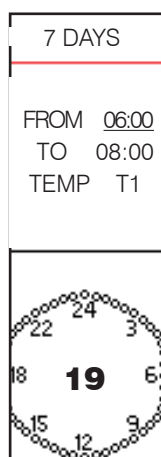

Press the "+/-" buttons to change the switch-on time. Hold the button down to scroll through the times more quickly.

Press the "OK" button to confirm and go to the end time setting.

Press the "+/-" buttons to change the switch-off time. Hold the button down to scroll through the times more quickly.

Press the "OK" button to confirm and go to the temperature selection (T1, T2 or T3).

Press the "+/-" buttons to switch between the temperatures.

To continue with other changes, press the "OK" button.

To choose between exit without saving and save, press the "M" button.

The following screen will appear.

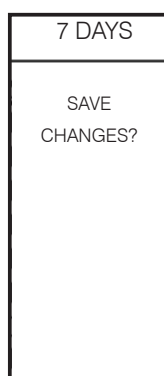

Press "M" to exit without saving
Press "OK" to save and go back to the screen

To view/change the settings ("CHANGE" on the display), from the Crono function, press the "OK" button. The following screen will appear.

Scroll to "CHANGE" (underlined) using the "+/-" buttons.

Press the "OK" button to confirm and select "CHANGE".

To go back to the previous screen press the "M" button.

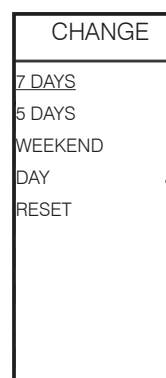

" +/- " scroll buttons
"OK" button to confirm

From the "CHANGE" function, in addition to changing/viewing the "7 DAYS", "5 DAYS", "WEEKEND", "DAY" programming, you can **erase all time settings using the "RESET" function.**

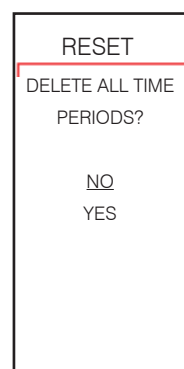

Use the "+/-" buttons to switch between YES and NO
"OK" button to continue with other changes

Night (deferred switching on/off)

This function switches the product on/off after a set period from activation of the function.
This is convenient if you go to bed and want the product to switch on/off after a few hours (12 hours maximum).

Activating the Night function

To access the function from the main menu (as indicated in the Menu section above), press the M button. Scroll using the +/- buttons and select the function by pressing OK.
Use the "+/-" buttons to activate/deactivate the function.
To exit without saving, press the "M" button.
Confirm by pressing the "OK" button for two seconds.

Setting the hours

Press "+" to increase the duration.
To exit without saving, press the "M" button.
Confirm by pressing the "OK" button for two seconds.
Press ON/OFF to return to the main screen.

With the Night Function active, the display shows the moon in the top left corner.
To quit the function, return to the menu and set the Night function to Deactivated. The procedure is the same as for activation.

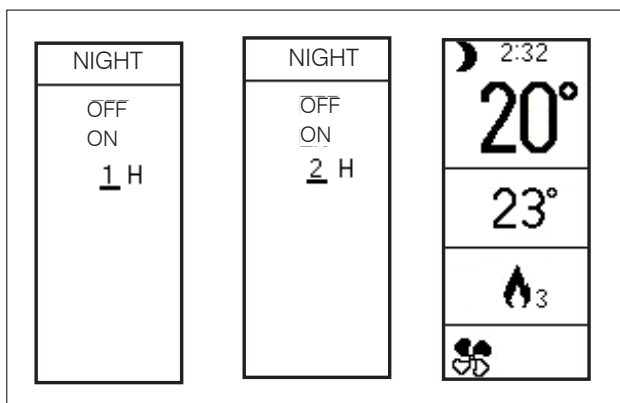
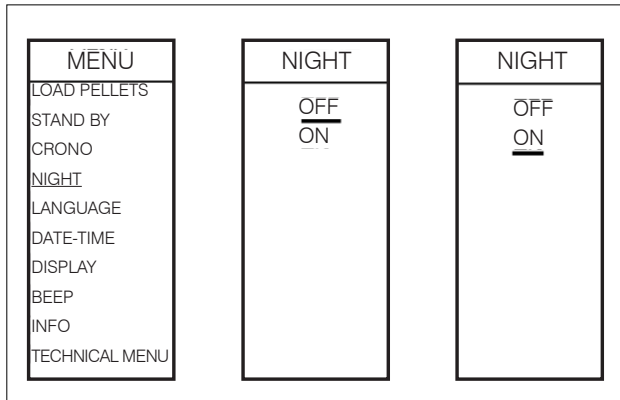

Load Pellets

Allows you to load pellets after the screw feeder has emptied following a no-pellets alarm.
Useful for the technician during commissioning.
Available only in the OFF state. If you attempt to activate the function in other states, access is not granted.
To access the function from the main menu (as indicated in the Menu section above), press the M button. Scroll using the +/- buttons and select the function by pressing OK.
Use the "+/-" buttons to activate/deactivate the function.
Press "M" to quit without saving.
Confirm by pressing the "OK" button for 2 seconds

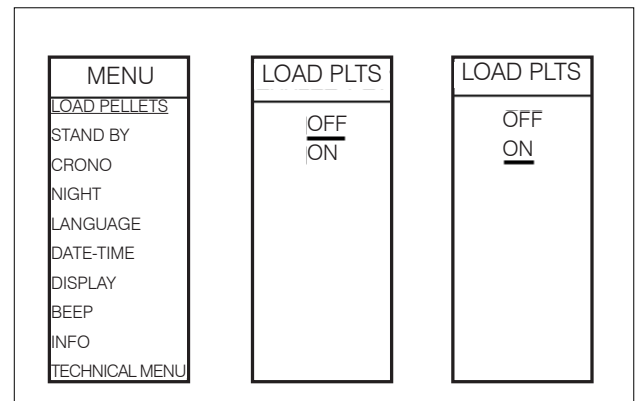

Language

Selects the language.
This displays the first time the remote control is activated with the product powered on, or by selecting the option from the menu.
To access the function from the main menu (as indicated in the Menu section above), press the M button. Scroll using the +/- buttons and select the function by pressing OK.
Use the "+/-" buttons to select the language.
To exit without saving, press the "M" button.
Confirm by pressing the "OK" button for two seconds.

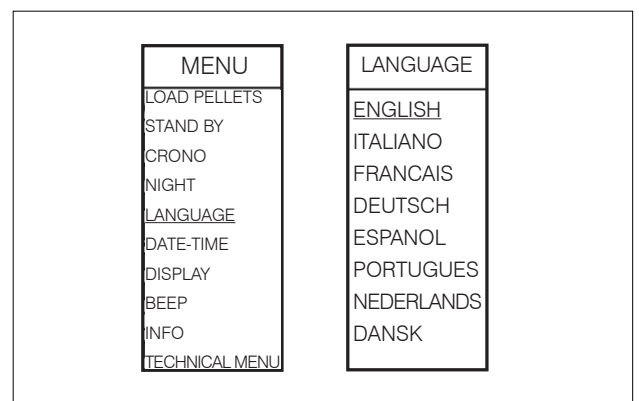

Date/Time

Sets the current date/time.

This displays the first time the remote control is activated with the stove powered on, or by selecting the option in the menu.

To access the function from the main menu (as indicated in the Menu section above), press the M button. Scroll using the +/- buttons and select the function by pressing OK.

Use the "+/-" buttons.

Press "M" to quit without saving.

Confirm by pressing the "OK" button for 2 seconds.

MENU LOAD PELLETS STAND BY CRONO NIGHT <u>DATE-TIME</u> DISPLAY LANGUAGE BEEP INFO TECHNICAL MENU	DATE - TIME THURSDAY 05 / 11 / 15 17 : 00	DATE - TIME THURSDAY 05 / 11 / 15 17 : 00
DATE - TIME THURSDAY 05 / 11 / 15 17 : 00	DATE - TIME THURSDAY 05 / 11 / 15 17 : 00	DATE - TIME THURSDAY 05 / 11 / 15 17 : 00

Display

It allows you to choose the background of the display, from white to black, or deactivate the lighting (Led ON - Led OFF).

To access the function from the main menu (as indicated in the Menu section above), press the M button. Scroll using the +/- buttons and select the function by pressing OK.

Use the "+/-" buttons to select the colour.

Press "M" to quit without saving.

Confirm by pressing the "OK" button for 2 seconds

MENU LOAD PELLETS STAND BY CRONO NIGHT DATE-TIME <u>DISPLAY</u> LANGUAGE BEEP INFO TECHNICAL MENU	DISPLAY WHITE BLACK	DISPLAY WHITE BLACK
--	----------------------------------	----------------------------------

Beep

Allows you to enable/disable the beep.

To access the function from the main menu (as indicated in the Menu section above), press the M button. Scroll using the +/- buttons and select the function by pressing OK.

Use the "+/-" buttons to select On/Off.

Press "M" to quit without saving.

Confirm by pressing the "OK" button for 2 seconds.

Info

These readings should only be done when requested by the technician.

The technician understands the diagnostic meaning of the messages and numbers, and may ask you to read them to him/her if you experience problems.

Technical menu

Accessible only to an authorised technician with the appropriate password.

Before doing any maintenance, disconnect the appliance from the mains.

Regular maintenance is essential to keeping the appliance in good working order.

FAILURE TO SERVICE THE Fireplace WILL PREVENT IT FROM WORKING PROPERLY.

Any problems due to failure to service the fireplace will void the warranty.

N.B.

- Any unauthorised modification is forbidden**
- Use spare parts recommended by the manufacturer**
- The use of counterfeit parts results in the guarantee becoming null and void**



Never vacuum hot ash, it can make the vacuum cleaner breakdown and represents a fire risk.



Do not empty the residue out into the pellet hopper.

The only maintenance to be done by the user (described in the following pages) must be done in the hearth compartment **(A)**. We remind you that the product must be switched off and cold.

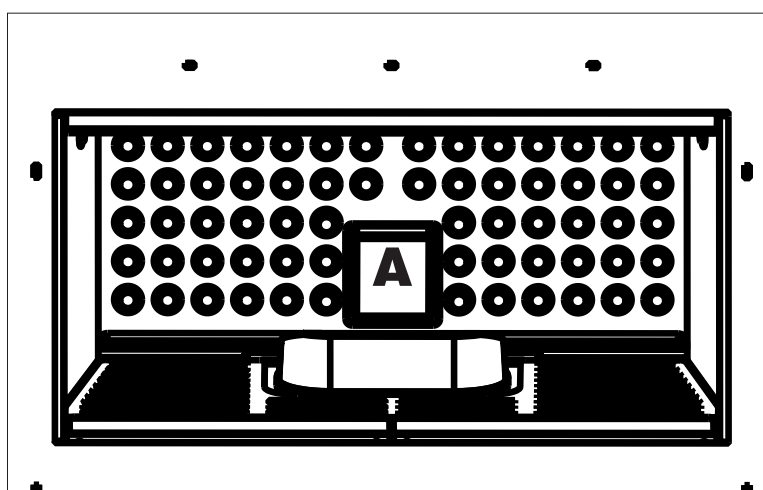

DAILY MAINTENANCE

This must be done with the appliance switched off and cold.

It must be done with a vacuum cleaner

The entire procedure takes just a few minutes.

- Open the door and remove the grate **(1)** in two parts.
- Remove the grille **(2)**
- Empty the ash tray **(3)** and grate into a non-flammable container (the ashes may still contain embers and/or hot parts).
- Vacuum out the interior of the hearth, the bed, and the compartment around the grate into which the ash falls.
- Scrape the grate with the provided scraper and clean out any obstructed holes.
- If necessary, clean the glass (when cold)



Note that using the fireplace without cleaning the grate can cause the gas in the combustion chamber to ignite and break the door glass.



Once you have finished cleaning the fireplace, make sure the grate is PROPERLY SEATED; failure to do so can cause the fireplace to malfunction.

Before starting up the fireplace, make sure the grate is seated properly without ash or uncombusted matter trapped around its border

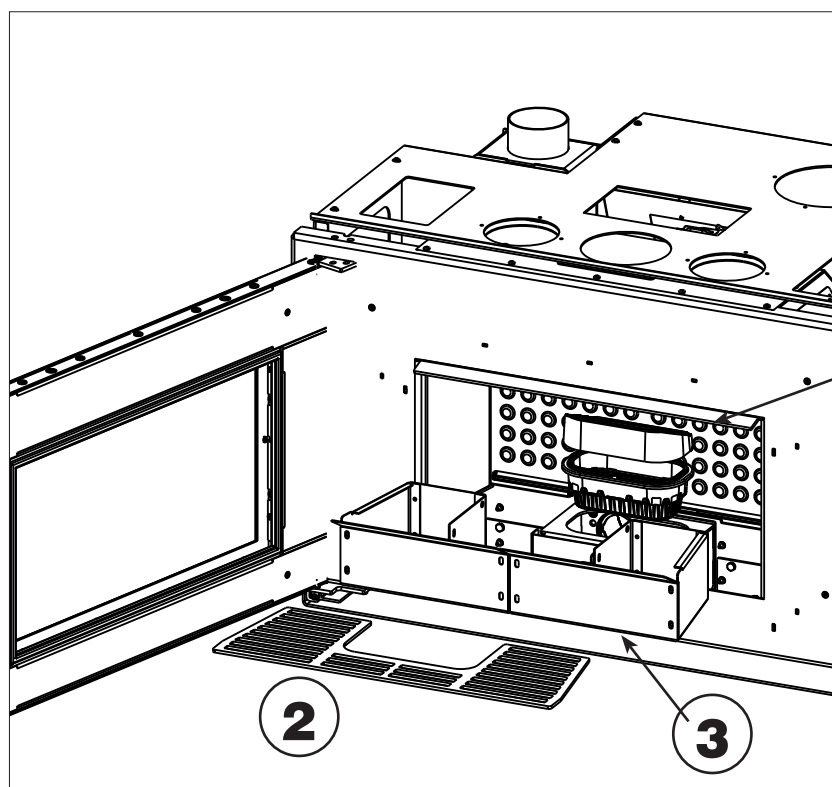

WEEKLY MAINTENANCE

Remove the deflectors **(D)** and clean with the vacuum.

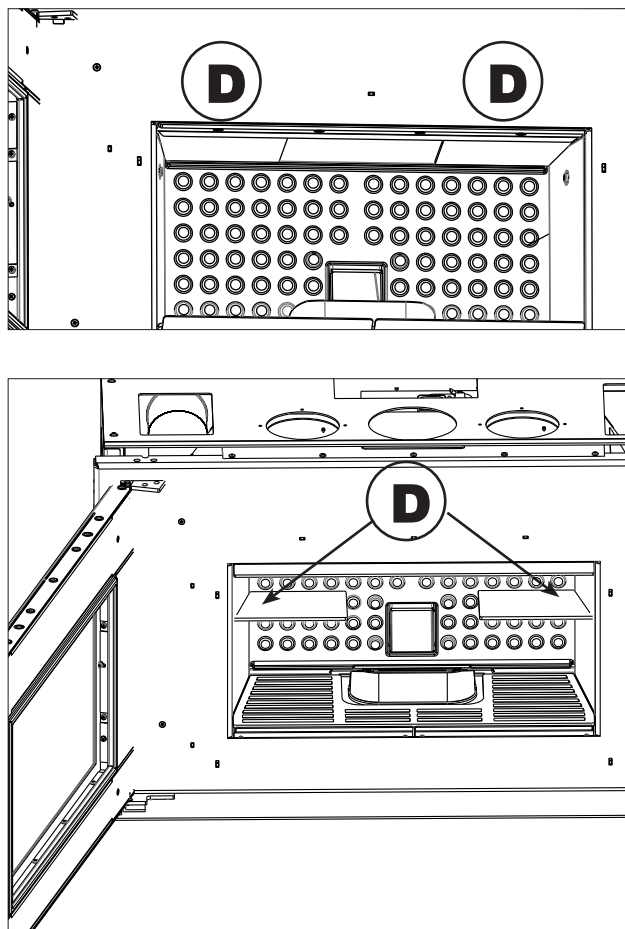

SEASONAL MAINTENANCE

(implemented by the DEALER)

Clean the fireplace internally and externally

In the event of very frequent use of the oven, it is advised cleaning of the smoke passage duct and smoke channel every 3 months.

You should clean the chimney system at least once a year (check local regulations for details).

If you fail to regularly clean and inspect the system, there is an increased risk of the chimney pot catching fire.

SUMMER SHUTDOWN

During the period of disuse, keep the fireplaces doors, hatches and lids closed.

We recommend emptying out the pellet tank.

SPARE PARTS

For any spare parts, contact your reseller or technician. Using non-original spare parts may damage the appliance and relieves Edilkamin of all liability for damage resulting therefrom.

DISPOSAL

At the end of its service life, dispose of the product as required by regulations.

Deliver to the special recycling centres.

The remote control's exhausted batteries must also be disposed of in a regulatory manner.

If problems occur, the fireplace shuts itself off automatically.

The display will show the reason (see below).

DO NOT disconnect the electrical power supply.

To start the product up again, allow the shutdown procedure to complete, then press the remote control's ON/OFF button or the simplified ignition button.

Before starting the product up again, check the reason for the shutdown and CLEAN THE GRATE.

The product is equipped with a safety valve but, if the grate is not cleaned regularly as explained above, ignition may involve a small detonation. If white smoke forms in the combustion chamber for a long time, disconnect the mains supply and wait 30 minutes before opening the door and emptying out the grate.

SHUTDOWN MESSAGES AND THEIR SOLUTIONS:

MESSAGE	PROBLEM	SOLUTION
H01	cuts in if the electronic circuit board detects an insufficient quantity of combustion air.	<ul style="list-style-type: none"> • Check that the firebox door is closed • Check that the grate and fume discharge are clean • Check that the external air inlet is free (i.e. the grilles are not obstructed) • Contact a technician if the problem persists
H02	displays when the logic board is not detecting the right fumes fan speed	<ul style="list-style-type: none"> • Contact the technician
H03	displays when the thermocouple detects a fume temperature lower than the set value and interprets this as the absence of flame	<ul style="list-style-type: none"> • Check that there are pellets in the tank • Contact the technician
H04	displays when ignition times out unsuccessfully	<p>There are two possibilities:</p> <p>NO FLAME PRESENT</p> <ul style="list-style-type: none"> • Check that the grate is seated properly and clean • Check that there are pellets in the tank and grate • Use a bit of solid paraffin to ignite the fireplace (contact the technician first) <p>FLAME PRESENT</p> <ul style="list-style-type: none"> • Contact the technician
H05	NOT available on this model	
H06	displays when the logic board determines that the fumes thermocouple is broken or disconnected	Contact the technician

MESSAGE	PROBLEM	SOLUTION
H07	Shutdown due to exceeding maximum fumes temperature.	<ul style="list-style-type: none"> Check the type of pellet (contact the technician if in doubt) Contact the technician
H08	Shutdown due to overheating in the product	<ul style="list-style-type: none"> please see H07
H09	Shutdown due to gearmotor failure.	<ul style="list-style-type: none"> Contact the technician
H10	Shutdown due to exceeding maximum motherboard temperature	<ul style="list-style-type: none"> Contact the technician
H11	Shutdown for pressostat security	<ul style="list-style-type: none"> Check that the fireplace, exhaust duct Contact the technician
H12	Problem in the thermostat. the product works only in manual mode	<ul style="list-style-type: none"> Contact the technician

MESSAGES WHICH DO NOT SHUT THE Fireplace DOWN, BUT ARE SIMPLY WARNINGS

LOW REMOTE CONTROL BATTERY LEVEL:

The battery symbol displays on the remote's display if the battery is low.

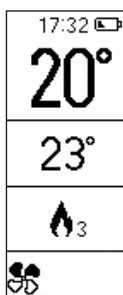

MAINTENANCE:

A wrench symbol is shown on the display after 2000 hours of operation.

The product is working, but it must be serviced by an authorised Edilkamin technician.

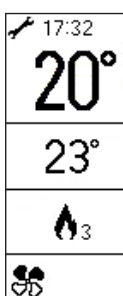



EDILKAMIN
TECNOLOGIA DEL FUOCO

www.edilkamin.com

cod. 942077-GB 04.19/A